



FORESTRY and PARKS DEPARTMENT

CLARK COUNTY COURTHOUSE
517 COURT ST., ROOM 103, NEILLSVILLE, WISCONSIN 54456
715-743-5140
www.clarkcountywi.gov

October 1, 2023

TO: All persons interested in winter storage at the Clark County Fairgrounds

RE: Timetable and conditions for storage

Clark County will again offer vehicle storage opportunities at the Fairgrounds for this winter. Storage is on first come – first serve basis. **All gates will be locked with no admittance beyond the staging area off of Rock Road prior to 8:00 a.m. on Saturday, November 4, 2023.** At 8:00 a.m. in the staging area storage customers will be directed to the appropriate building for the size of their item to be stored. Storage pull-in will continue until approximately 11:00 a.m. (Storage pull-out is scheduled for April 6, 2024 starting at 8:00 a.m. for all items, and will continue up to approximately 11:00 a.m. or until all items are removed.) Please note, overnight parking prior to pull-in is prohibited and any vehicle left unattended will be subject to towing and related fees. Early/Late storage pull-in is available beginning on October 21st for a fee of \$50 per customer (limit one trip). Additional trips for multiple vehicles will be charged separately. Please contact Daryn Horn, CCFP Facilities Supervisor for individual appointments at 715-937-3845.

Enclosed is a contract for storage – **each item stored must have a separate contract.** Please make additional copies as needed and bring the completed form(s) and appropriate individual payment(s) for each contract, to turn in on the date of storage pull-in. If a copy is desired for your records, please make it before you arrive since we will not have the capability to make copies on the date of storage pull-in. **All stored items must have all batteries, fuel cans, LP tanks, etc. removed prior to storage.**

Items being stored will be measured from “nose to tail” including any hitches or extensions protruding beyond the stored item. Storage fees are as follows with checks to be made payable to the Clark County Treasurer:

- Items less than 20 feet in length – **\$150.00** for Nov. 4, 2023 to Apr. 6, 2024.
- Items 20 to 30 feet long – **\$200.00** for Nov. 4, 2023 to Apr. 6, 2024.
- Items greater than 30 feet in length – **\$250.00** for Nov. 4, 2023 to Apr. 6, 2024.

All fees and forms will be collected at the pull-in event.

Thank you for your interest in our winter storage opportunities at the Clark County Fairgrounds. If you have any questions, please contact us via the email address or phone number below.

Mary Olson-Back

Office Business Manager
Clark County – Forestry & Parks Dept.
517 Court Street, RM 103
Neillsville, WI 54456
Office: 715-743-5140
Email: mary.olson-back@co.clark.wi.us

TIMBER • RECREATION • WILDLIFE

Clark County, WI



Founded in 1853

10

E. Division St.

10

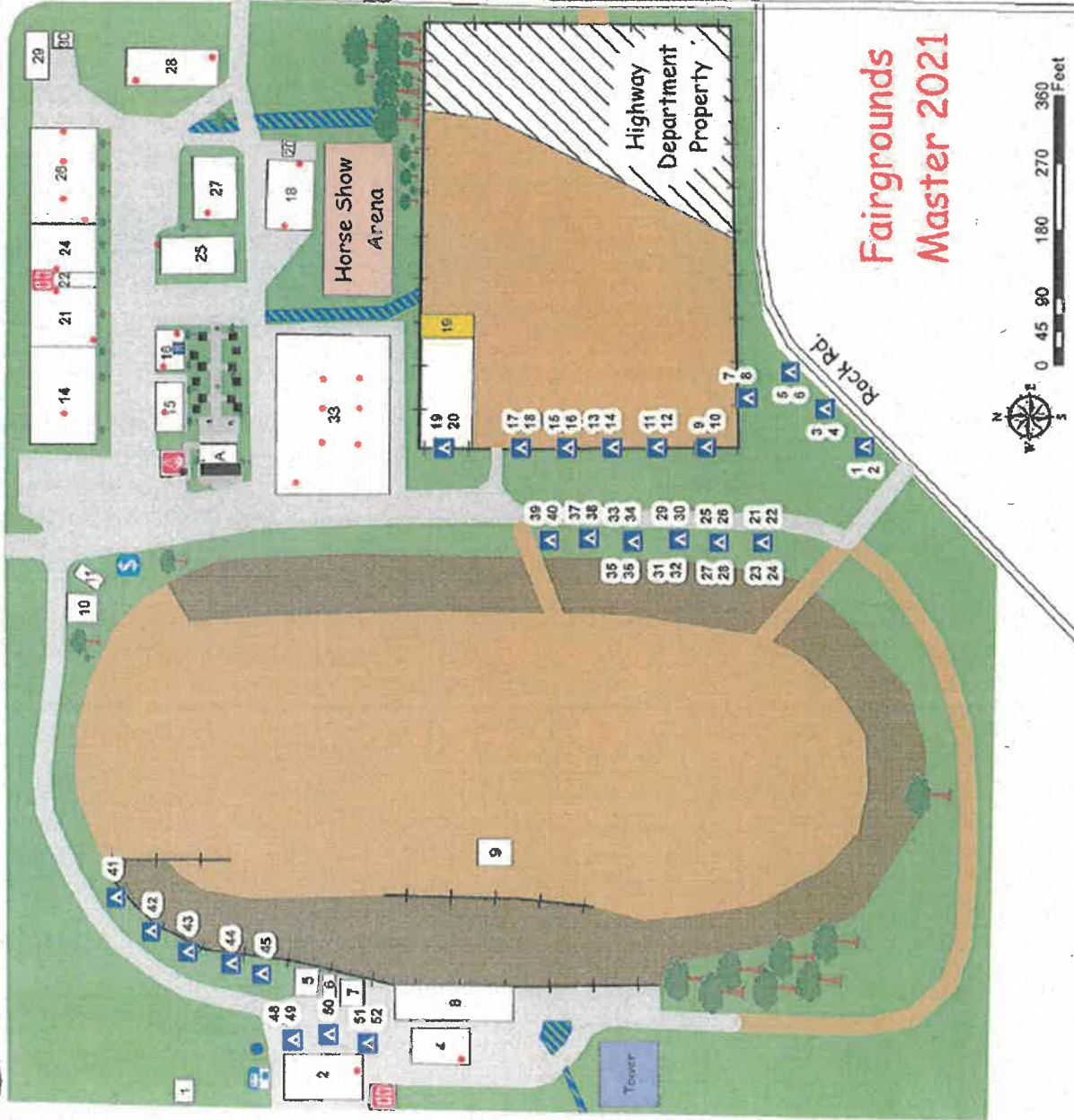

Fairgrounds Master 2021



0 45 90 180 270 360 Feet

- 1 Restroom
 - 2 Quonset Hut
 - 3 Restrooms
 - 4 Entertainment Center
 - 5 Neillsville High School VICA
 - 6 Kenny Schultz
 - 7 Optimist Club
 - 8 Grandstand
 - 9 Men's Club Food Stand
 - 10 DNR Building/Log Cabin
 - 11 Kiwanis Club/Lil Red Barn
 - 12 Bathroom/Shower Building
 - 14 Fine Arts Building
 - 15 Plants & Soils/Fairboard Office
 - 16 4H Food Stand/HCE Dairy Bar
 - 18 Horse Barn
 - 19 Draft Horses (if needed)
 - 20 Horse Wash Rack
 - 21 Dining Hall
 - 22 Bathrooms, Kitchen & Office
 - 24 Show Ring
 - 25 Goat/Llama Barn
 - 26 Jr. Dairy Barn
 - 27 Rabbit/Poultry Barn
 - 28 Open Class Dairy
 - 29 Dairy Barn Wash Rack
 - 30 Manure Bunker
 - 33 Multipurpose Livestock W/Arena
 - A Bandshell
- Gravel Surface
 - Paved Surface
 - Water
 - Self-Registration Station
 - Showers & Flush Toilets
 - Flush Toilets
 - Sanitary Dump Station
 - Fencing
 - Fire Extinguisher Location
 - Campsites



Clark County Fairgrounds

1121 East Division St
Neillsville, WI 54456



FORESTRY and PARKS DEPARTMENT

CLARK COUNTY COURTHOUSE
517 COURT ST., ROOM 103, NEILLSVILLE, WISCONSIN 54456
715-743-5140
www.clarkcountywi.gov

FAIRGROUNDS STORAGE CONTRACT

THIS INDENTURE, Made this **4th day of November, 2023** by and between the Clark County Forestry and Parks Committee, party of the first part, Lessor and

PRINTED NAME

STREET ADDRESS, CITY, STATE, ZIP

PHONE NO.

EMAIL

party of the second part, Lessee.

WITNESSED, That the said party of the first part, in consideration of the rents and covenants, hereinafter mentioned does hereby Demise, Lease and Let unto the said party of the second part, and the said party of the second part does hereby hire and take from the said party of the first part, the following described premises, situated in the County of Clark, and the State of Wisconsin via one of the following places of storage at the Clark County Fairgrounds: Quonset Hut (Bldg. 2); Entertainment Center (Bldg. 4); Show Ring (Bldg. 24); Goat/Llama Barn (Bldg. 25); Jr. Dairy Barn (N. side Bldg. 26); Jr. Dairy Barn (Middle Bldg. 26); Jr. Dairy Barn (S. side Bldg. 26); Rabbit/Poultry Barn (Bldg. 27); Open Class Dairy (Bldg. 28); Multipurpose Livestock Barn (Bldg. 33).; etc.

Storage Item Description

Item ID No.

Item Value

TO HAVE AND HOLD, The above rented premised unto the said Lessee, heirs and assigns, for and during the term from the **4th day of November, 2023** until the **6th day of April, 2024**. And the said Lessee agrees to and with the said Lessor to pay as rent for the above mentioned premises the sum of _____ dollars as full payment for term of this lease due at the commencement of this lease.

That the Lessee shall hold harmless Clark County, its agents and representatives from any liability for any damage for any cause whatsoever to said Lessee's property or belongings stored or located upon the premises leased from Clark County and the Lessee shall defend Clark County in any such claim.

That the Lessee, shall maintain sufficient insurance on all personal property which Lessee so deems appropriate. That said insurance is the only recourse for recapture of loss. Lessee is solely responsible for insuring its own property.



Clark County assumes no responsibility for damages to any property stored. Lessee has by signing, acknowledged inspecting the premises and finds them safe and adequate as is for the storage of Lessee's property.

That the Lessor does not grant permission to the Lessee to sublet the above rented premises or parts thereof.

And the said Lessee also covenant and agrees to and with the said Lessor not to assign this Lease without first obtaining the written consent of the said Lessor, and that Lessee will, at the expiration of the time herein recited, quietly yield and surrender the aforesaid premises to the said Lessor heirs and assigns, in as good condition and repair as when Lessee took them, reasonable wear and tear and damage by the elements alone accepted.

And the said Lessee agrees that the purpose of this indenture is to facilitate long-term storage. That stored vehicles may not be available for intermittent pull-in and pull-out. The extra costs incurred for early or late pull-in or pull-out, or showing of any vehicle for sale, will be at Lessee's expense. **All stored items must have all batteries, fuel cans, LP tanks, etc. removed prior to storage.**

Other Conditions: _____

IN TESTIMONY WHEREOF, Both parties have hereunto set their hands and seals the day and year first above written.

LESSEE

DATE

COUNTY AGENT

DATE

FOR OFFICE USE ONLY: (Circle, check mark, & fill in blank)

Place of Storage:

- | | | |
|--|--|--|
| <input type="checkbox"/> Quonset Hut (Bldg 2) | <input type="checkbox"/> Jr. Dairy Barn (N.side Bldg 26) | <input type="checkbox"/> Open Class Dairy (Bldg 28) |
| <input type="checkbox"/> Entertainment Center (Bldg 4) | <input type="checkbox"/> Jr. Dairy Barn (Middle Bldg 26) | <input type="checkbox"/> Multipurpose Barn (Bldg 33=L, R, C) |
| <input type="checkbox"/> Show Ring (Bldg 24) | <input type="checkbox"/> Jr. Dairy Barn (S.side Bldg 26) | <input type="checkbox"/> \$50/trip Early Pull-In/Out |
| <input type="checkbox"/> Goat/Llama Barn (Bldg 25) | <input type="checkbox"/> Rabbit/Poultry Barn (Bldg 27) | <input type="checkbox"/> \$50/trip Late Pull-In/Out |

Cash or Check No.: _____ \$150 = <20' long \$200 = 20'-30' long \$250 = >30' long