

**CLARK COUNTY FOREST**  
**Firewood Permit Area 1-23**  
**NWNE Section 8,**  
**SWNW Section 16**  
**Township 25N Range 4W (South Foster)**

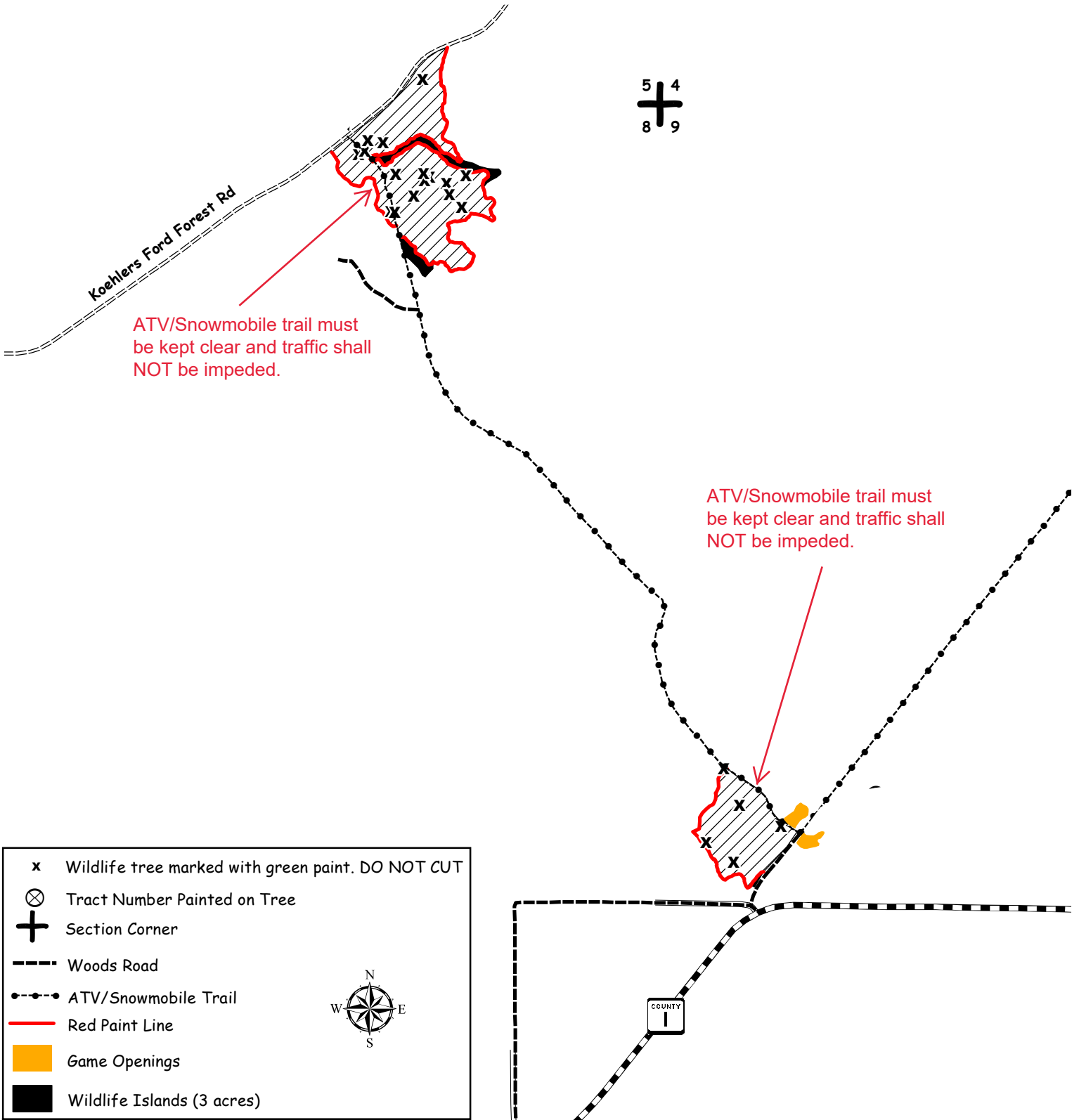

Firewood Permit Area. May harvest trim, cull pieces, and non-merchantable logging debris. Do not cut any standing trees (alive or dead), pulpwood, logs, or downed timber 8 feet or longer.



ATV/Snowmobile trail must be kept clear and traffic shall NOT be impeded.

ATV/Snowmobile trail must be kept clear and traffic shall NOT be impeded.

- x Wildlife tree marked with green paint. DO NOT CUT
- ⊗ Tract Number Painted on Tree
- + Section Corner
- Woods Road
- ATV/Snowmobile Trail
- Red Paint Line
- Game Openings
- Wildlife Islands (3 acres)



# CLARK COUNTY FOREST

## Firewood Permit Area 2-23

Pt. of SWNE Section 18, Township 24N Range 3W (Hewett);



Firewood Permit Area. May harvest trim, cull pieces, and non-merchantable logging debris. Do not cut any standing trees (alive or dead), pulpwood, logs, or downed timber 8 feet or longer.

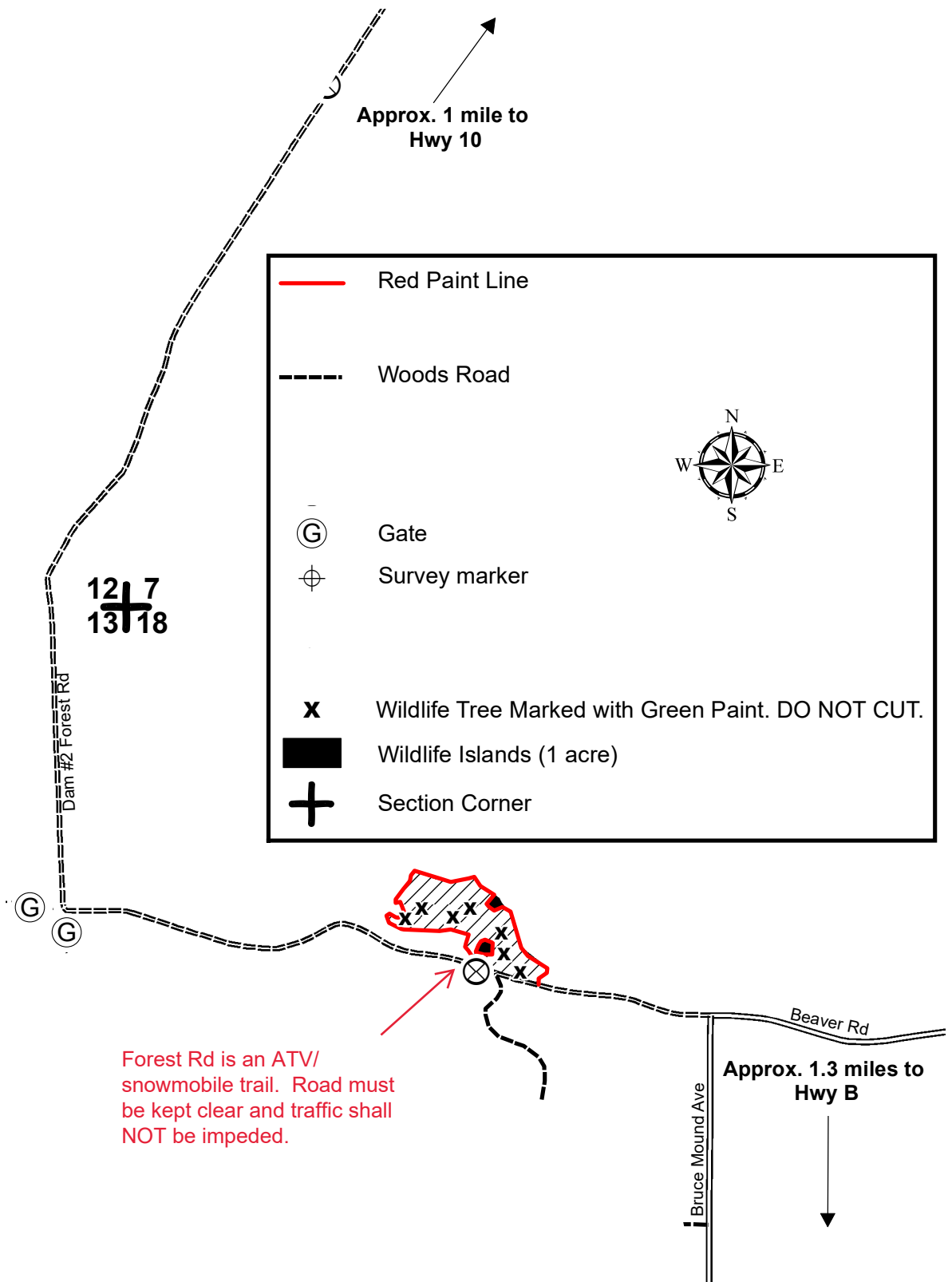

**CLARK COUNTY FOREST**  
**Firewood Permit Area 3-23**  
**SENE, E1/2 SE 1/4 Section 28**  
**Township 23N Range 1E (Sherwood)**

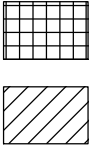

Firewood Permit Area. May harvest trim, cull pieces, and non-merchantable logging debris. Do not cut any standing trees (alive or dead), pulpwood, logs, or downed timber 8 feet or longer.

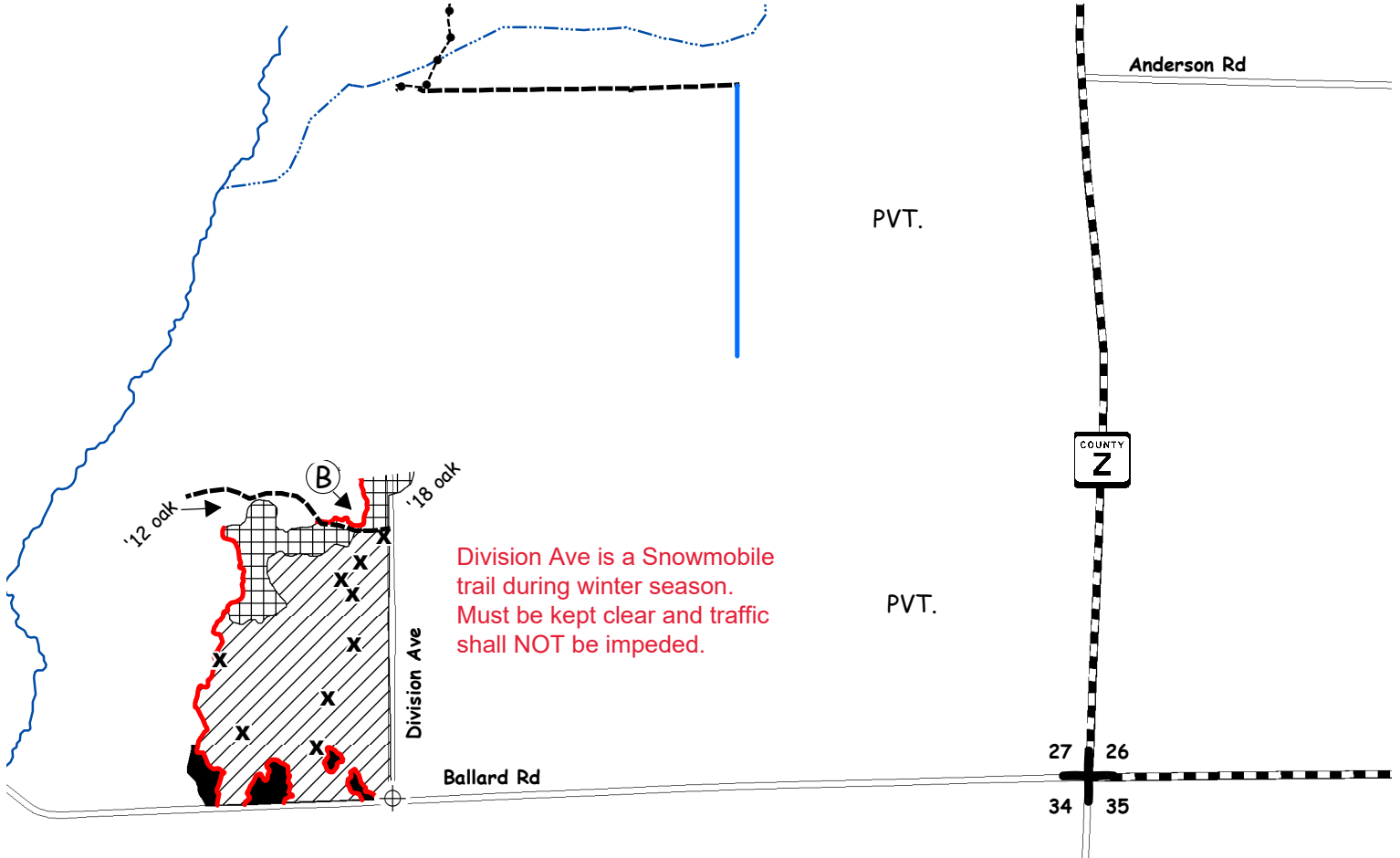

Division Ave is a Snowmobile trail during winter season. Must be kept clear and traffic shall NOT be impeded.



- x** Wildlife Tree Marked with Green Paint. DO NOT CUT.
- $\oplus$  Survey Marker
- (G)** Gate
- (B)** Bunker
- +** Section Corner
- Woods Road
- .....** Intermittent Stream
- Perennial Stream
- Blue Paint Line
- Red Paint Line
- ▲** Sherwood Park Campground
- Wildlife Islands (5 acres)



# CLARK COUNTY FOREST

## Firewood Permit Area 4-23

Pt. of NENW, SENW Section 25  
Township 24N Range 3W (Hewett)

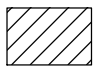

Firewood Permit Area. May harvest trim, cull pieces, and non-merchantable logging debris. Do not cut any standing trees (alive or dead), pulpwood, logs, or downed timber 8 feet or longer.

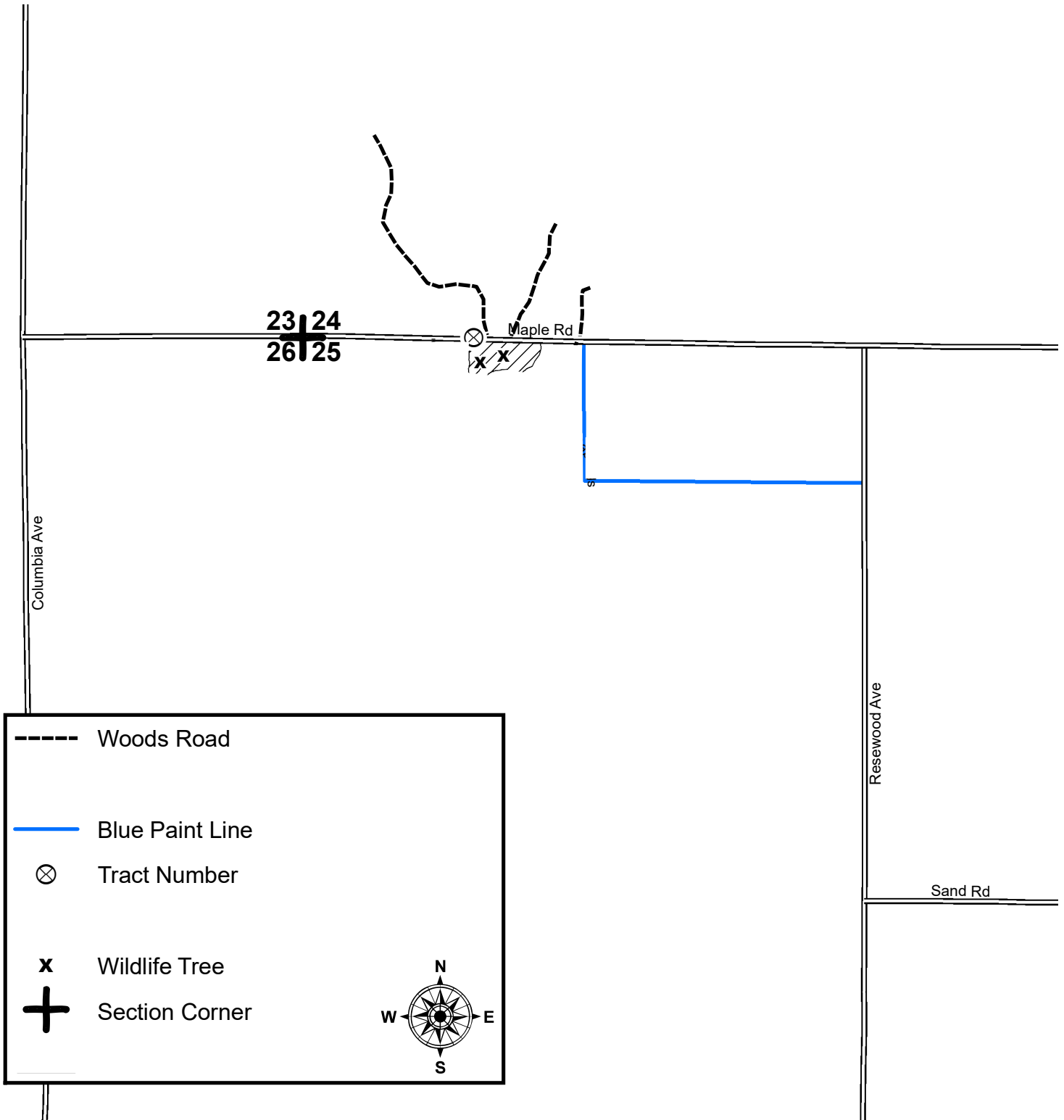

**CLARK COUNTY FOREST**  
**Firewood Permit Area 5-23**  
**SESW Section 35**  
**Township 25N Range 3W (Seif),**  
**N1/2 NW1/4 Section 2**  
**Township 24N Range 3W (Hewett)**



Firewood Permit Area. May harvest trim, cull pieces, and non-merchantable logging debris. Do not cut any standing trees (alive or dead), pulpwood, logs, or downed timber 8 feet or longer.



Access from Sterling Ave only. No vehicles past intersection.

ATV/Snowmobile trail must be kept clear and traffic shall NOT be impeded.

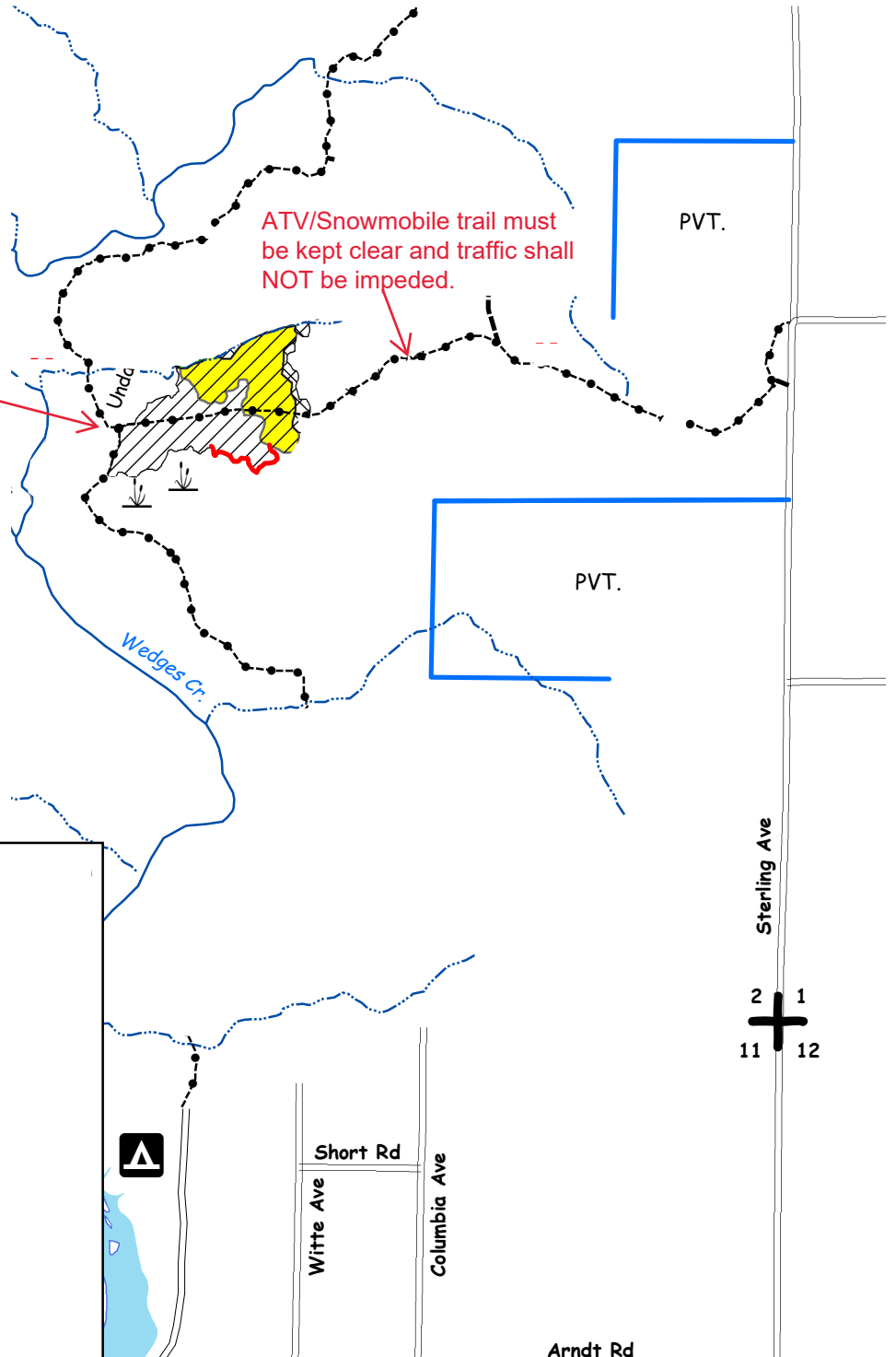

	Wetland
	Section Corner
	Snyder Park and Campground
	ATV/Snowmobile Trail
	Woods Road
	Intermittent Stream
	Perennial Stream
	Blue Paint Line
	Red Paint Line

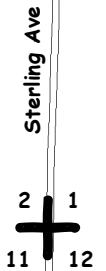

# CLARK COUNTY FOREST

## Firewood Permit Area 6-23

W 1/2 SE 1/4 Sec. 8

E 1/2 NW 1/4 Sec. 17

Township 27N Range 4W (Butler)



Firewood Permit Area. May harvest trim, cull pieces, and non-merchantable logging debris. Do not cut any standing trees (alive or dead), pulpwood, logs, or downed timber 8 feet or longer.

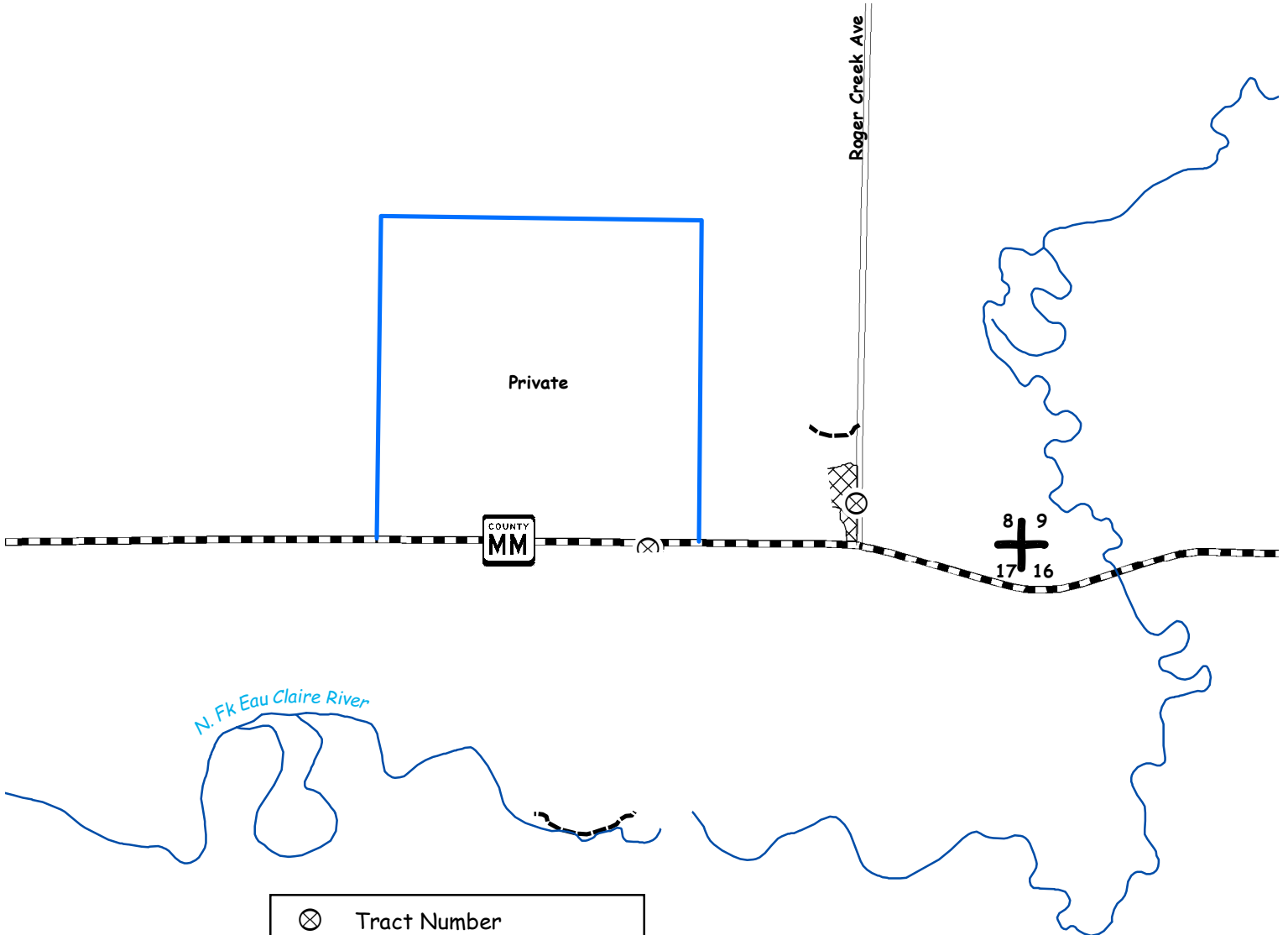

	Tract Number
	Section Corner
	Woods Road
	Perennial Stream
	Blue Paint Line

# CLARK COUNTY FOREST

## Firewood Permit Area 7-23

Pt. of S 1/2 Section 11  
Township 26N Range 4W (N. Foster)

Firewood Permit Area. May harvest trim, cull pieces, and non-merchantable logging debris.  
Do not cut any standing trees (alive or dead), pulpwood, logs, or downed timber 8 feet or longer.

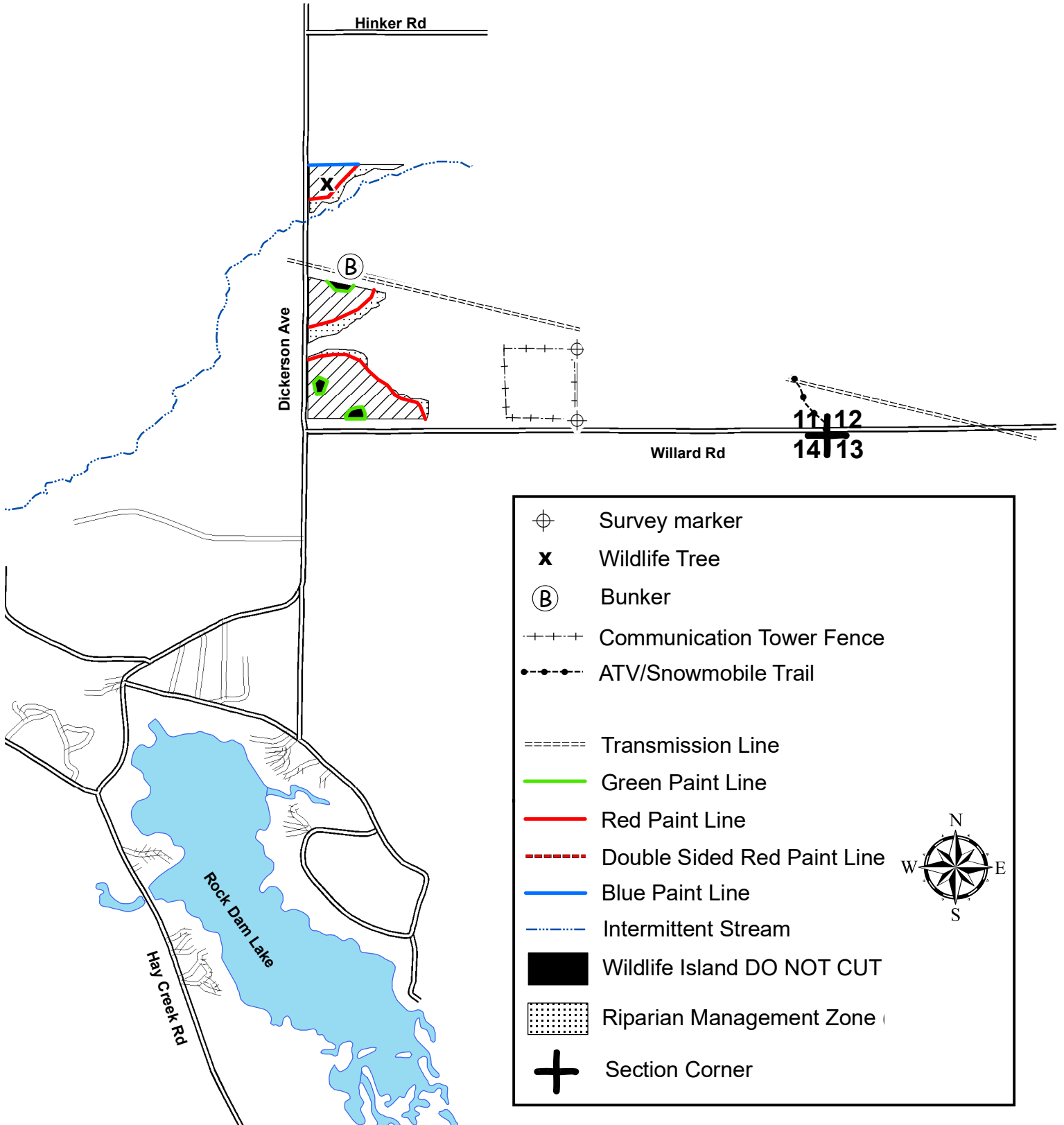

	Survey marker
	Wildlife Tree
	Bunker
	Communication Tower Fence
	ATV/Snowmobile Trail
	Transmission Line
	Green Paint Line
	Red Paint Line
	Double Sided Red Paint Line
	Blue Paint Line
	Intermittent Stream
	Wildlife Island DO NOT CUT
	Riparian Management Zone
	Section Corner

**CLARK COUNTY FOREST**  
**Firewood Permit Area 8-23**  
**Pt. of NW 1/4 Section 2**  
**Pt. of E 1/2 NE 1/4 Section 3**  
**Township 24N Range 4W (Mentor)**



Firewood Permit Area. May harvest trim, cull pieces, and non-merchantable logging debris. Do not cut any standing trees (alive or dead), pulpwood, logs, or downed timber 8 feet or longer.

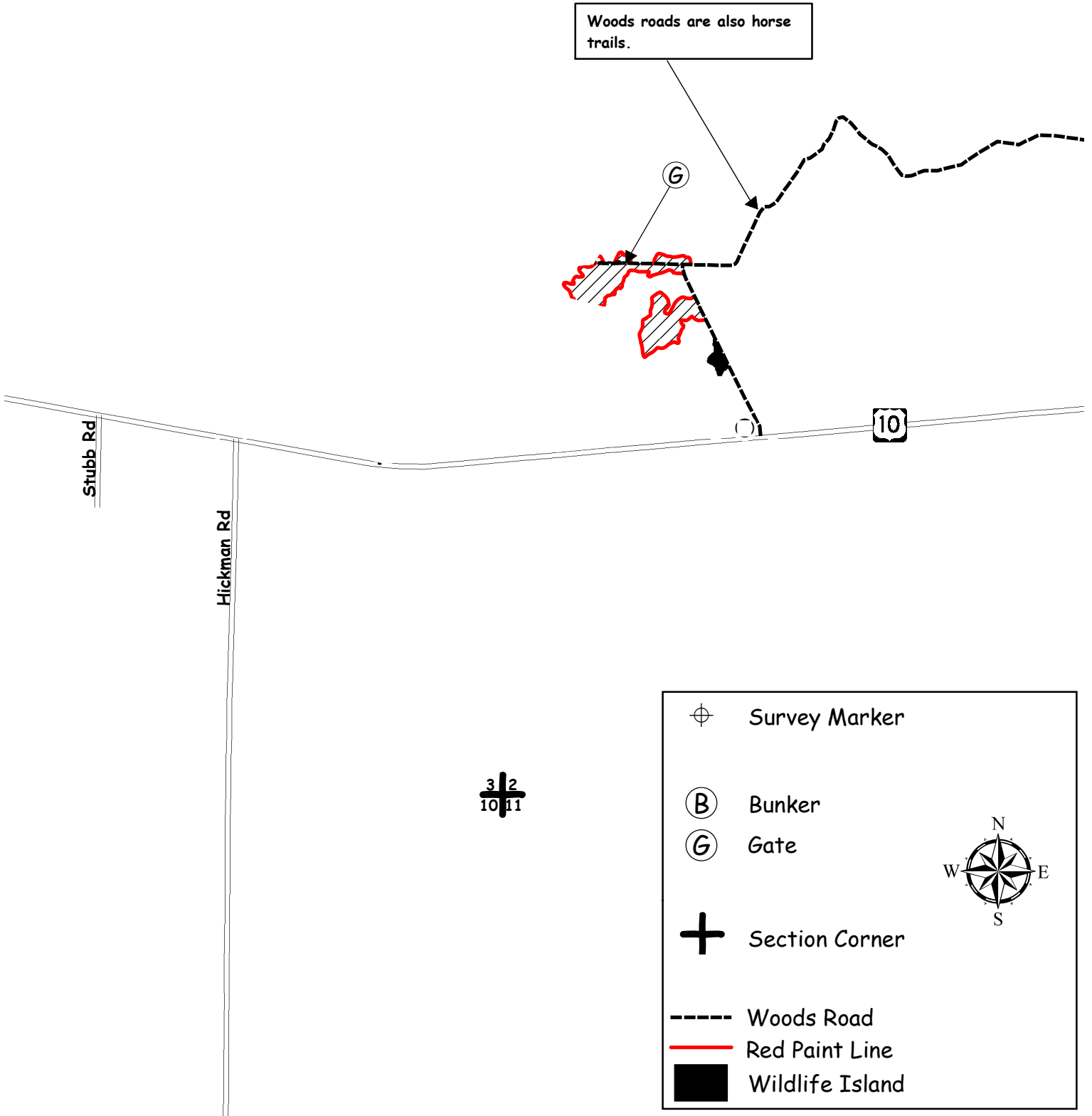

Woods roads are also horse trails.

	Survey Marker
	Bunker
	Gate
	Section Corner
	Woods Road
	Red Paint Line
	Wildlife Island



# CLARK COUNTY FOREST

Firewood Permit Area 9-23

Pt. of SESE Section 33

Township 25N Range 3W (Seif)



Firewood Permit Area. May harvest trim, cull pieces, and non-merchantable logging debris. Do not cut any standing trees (alive or dead), pulpwood, logs, or downed timber 8 feet or longer.



32 34  
+  
5 4

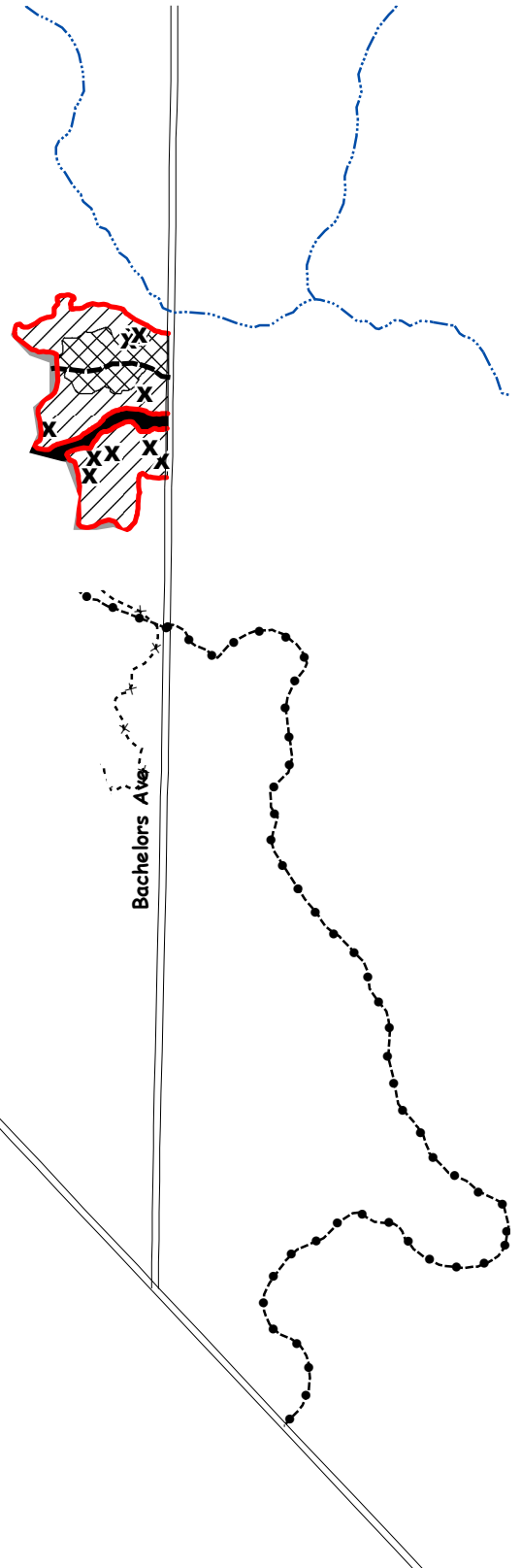

**X** Wildlife tree marked with green paint. DO NOT CUT

**+** Section Corner

--- Intermittent Stream

x---x Motorcycle Trail marked with two rings of green paint.

●---● ATV/Snowmobile Trail

--- Woods Road

— Red Paint Line



■ Wildlife Islands (9 acres)

# CLARK COUNTY FOREST

## Firewood Permit Area 10-23

Pt. of SWNW, SWSW, SESW Section 14  
Pt. of NENW, SWNE, SENE, NESE, SESE Section 23  
Township 26N Range 4W (N. Foster)



Firewood Permit Area. May harvest trim, cull pieces, and non-merchantable logging debris. Do not cut any standing trees (alive or dead), pulpwood, logs, or downed timber 8 feet or longer.

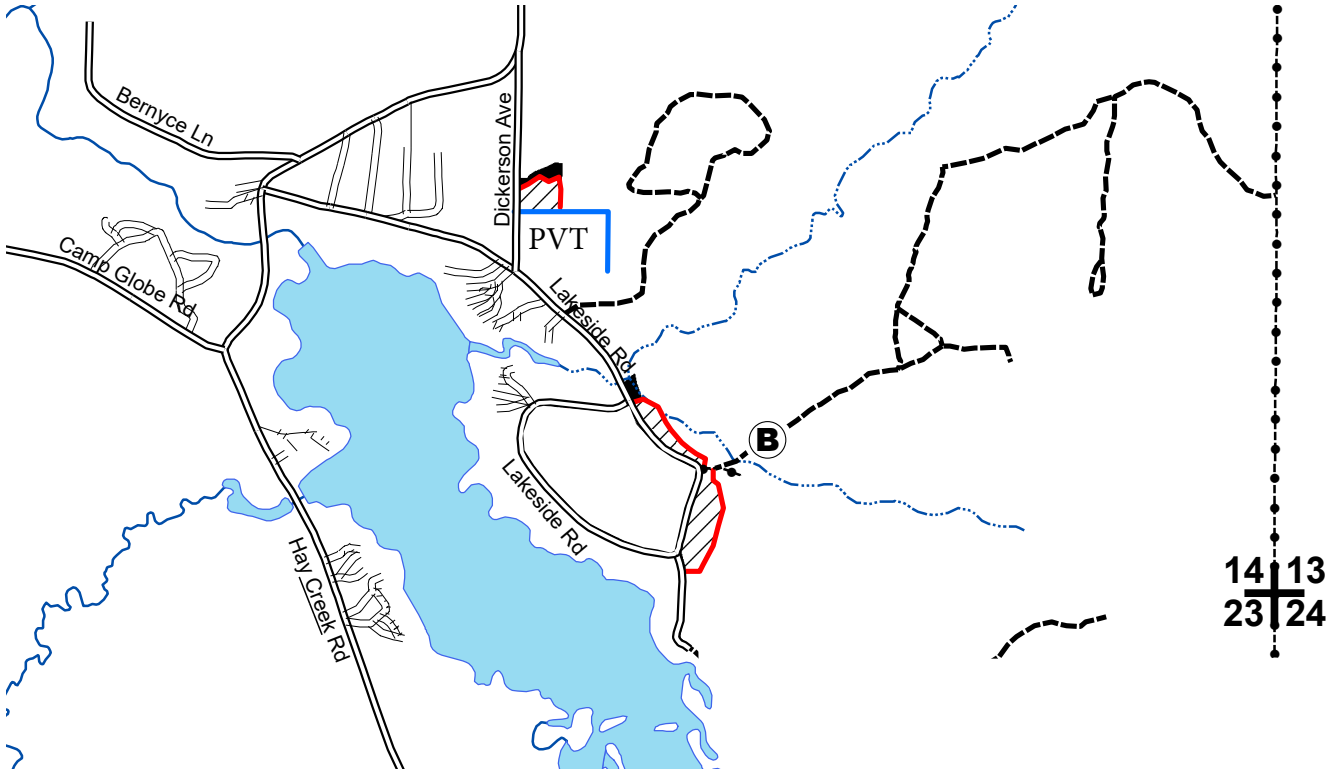

	Atv/Snowmobile Trail
	Woods Road
	Intermittent Stream
	Perennial Stream
	Red Paint Line
	Blue Paint Line
	Bunker
	Wildlife Island
	Section Corner



# CLARK COUNTY FOREST

## Firewood Permit Area 1-22

N 1/2 NW 1/4 & S 1/2 SE 1/4 Section 20,  
Township 27N Range 03W (Mead)

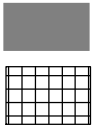

Firewood Permit Area. May harvest trim, cull pieces, and non-merchantable logging debris. Do not cut any standing trees (alive or dead), pulpwood, logs, or downed timber 8 feet or longer.

nt.

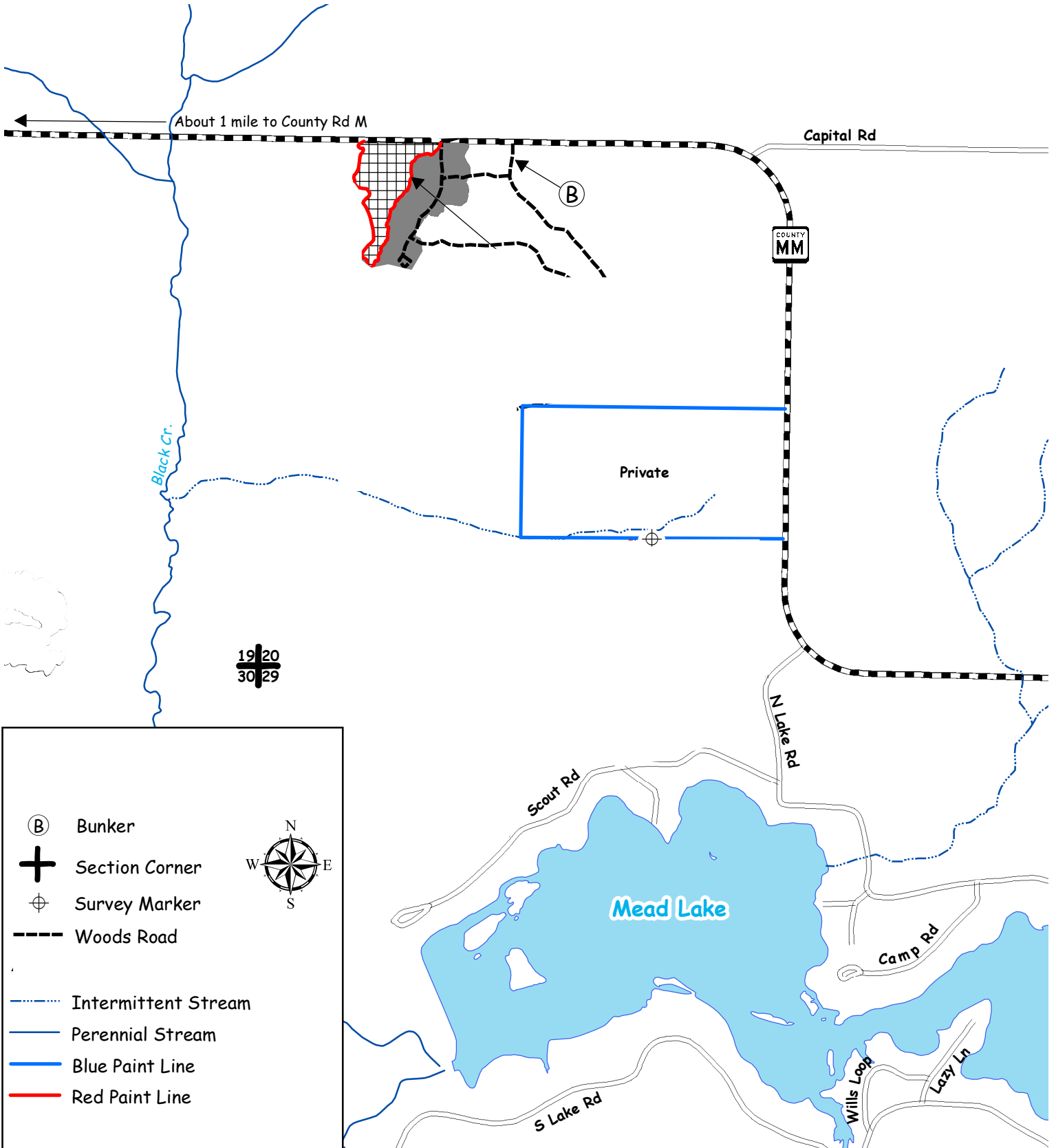

# CLARK COUNTY FOREST

## Firewood Permit Area 2-22

N 1/2 NW 1/4, SENW, SWSW Section 13,  
Township 26N Range 4W (North Foster)



Firewood Permit Area. May harvest trim, cull pieces, and non-merchantable logging debris. Do not cut any standing trees (alive or dead), pulpwood, logs, or downed timber 8 feet or longer.

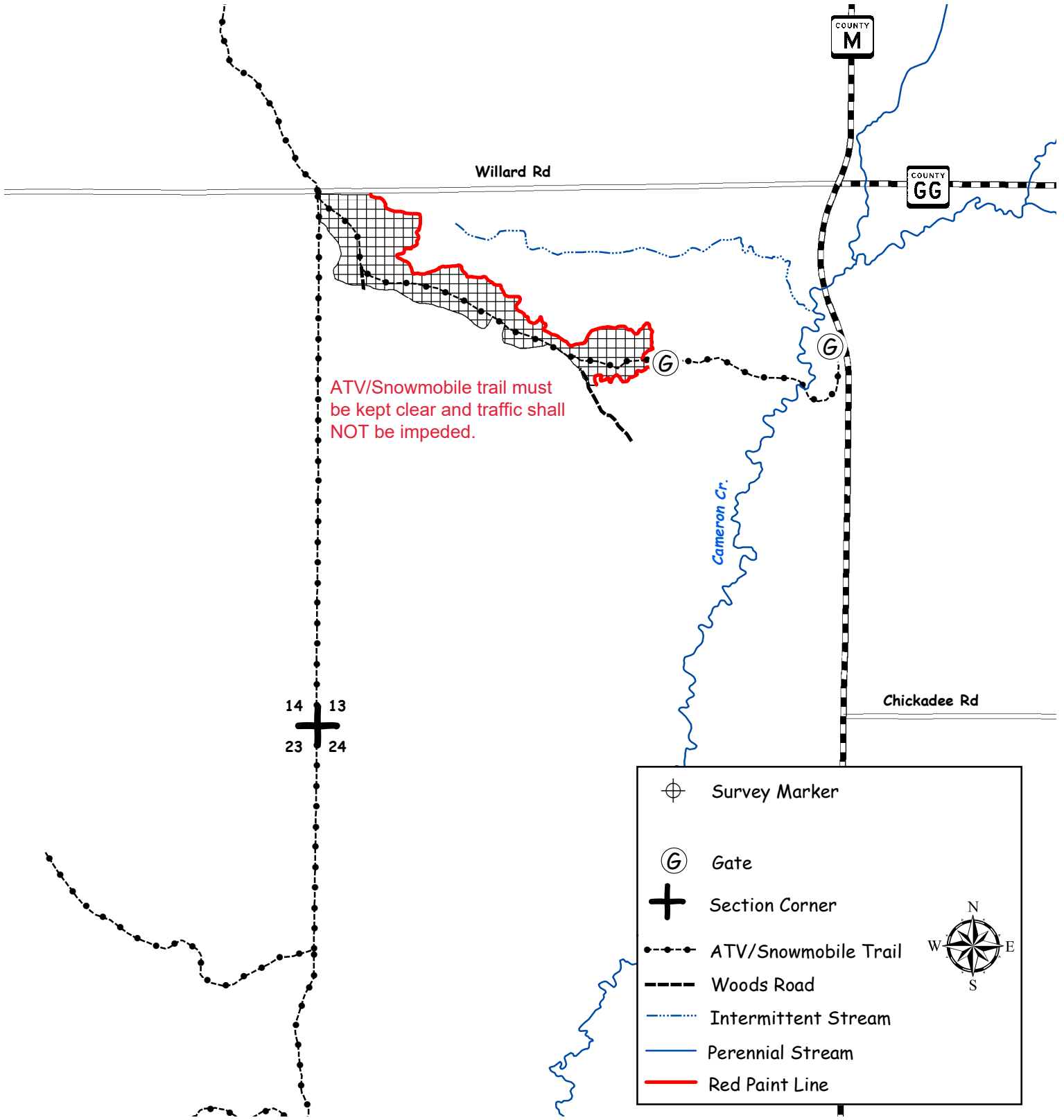

**CLARK COUNTY FOREST**  
**Firewood Permit Area 4-22**  
**W1/2 NW1/4 Section 29,**  
**E1/2 NE1/4 Section 30**  
**Township 25N Range 3W (Seif)**



Firewood Permit Area. May harvest trim, cull pieces, and non-merchantable logging debris. Do not cut any standing trees (alive or dead), pulpwood, logs, or downed timber 8 feet or longer.

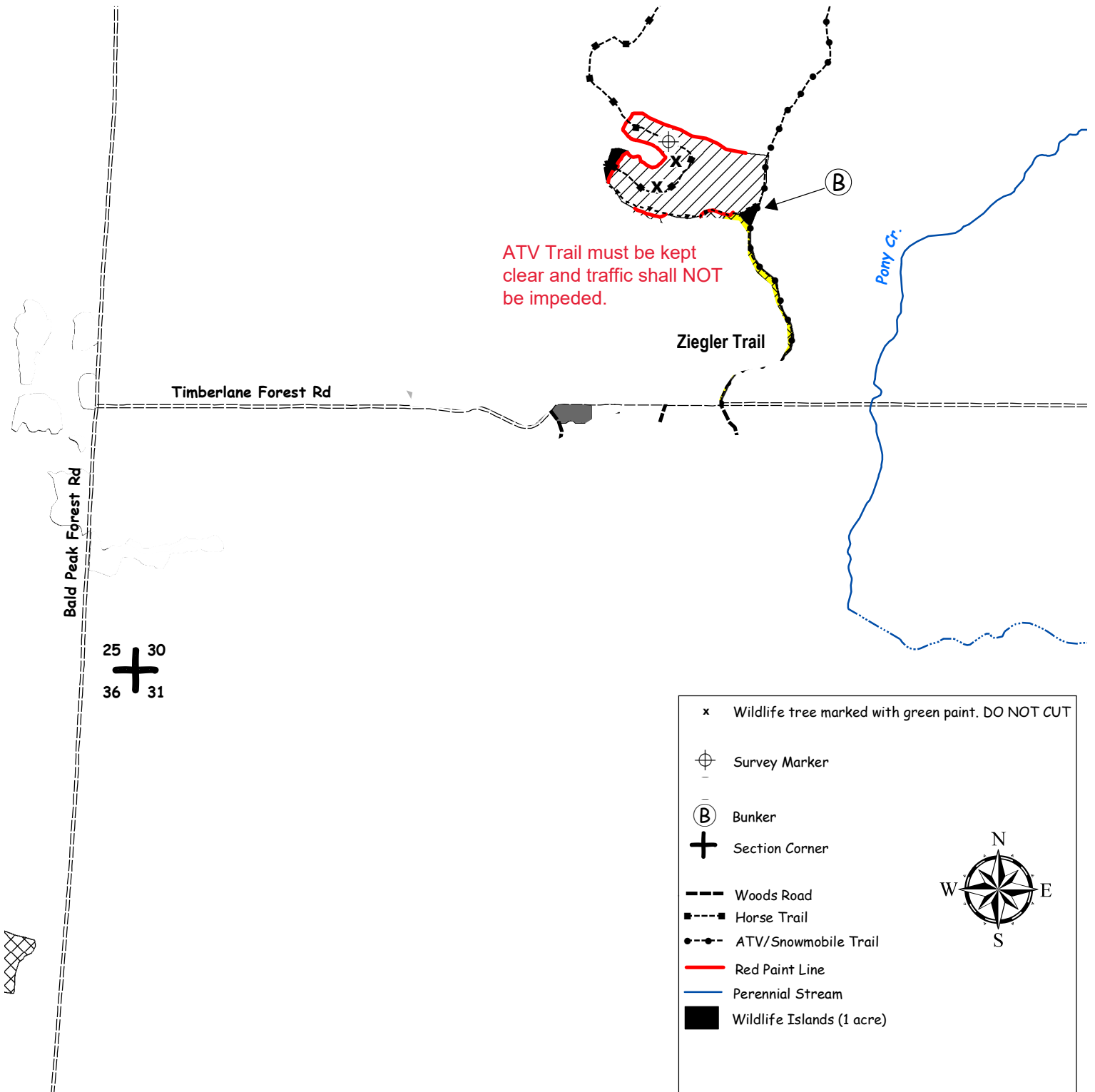

25 30  
 36 31

- x Wildlife tree marked with green paint. DO NOT CUT
- ⊕ Survey Marker
- Ⓟ Bunker
- + Section Corner
- Woods Road
- - - Horse Trail
- - - - ATV/Snowmobile Trail
- Red Paint Line
- Perennial Stream
- Wildlife Islands (1 acre)



**CLARK COUNTY FOREST**  
**Firewood Permit Area 5-22**  
**Pt. of S1/2 Section 7**  
**Township 25N Range 3W (Seif),**  
**E 1/2 SE 1/4 Section 12**  
**Township 25N Range 4W (South Foster)**



Firewood Permit Area. May harvest trim, cull pieces, and non-merchantable logging debris. Do not cut any standing trees (alive or dead), pulpwood, logs, or downed timber 8 feet or longer.

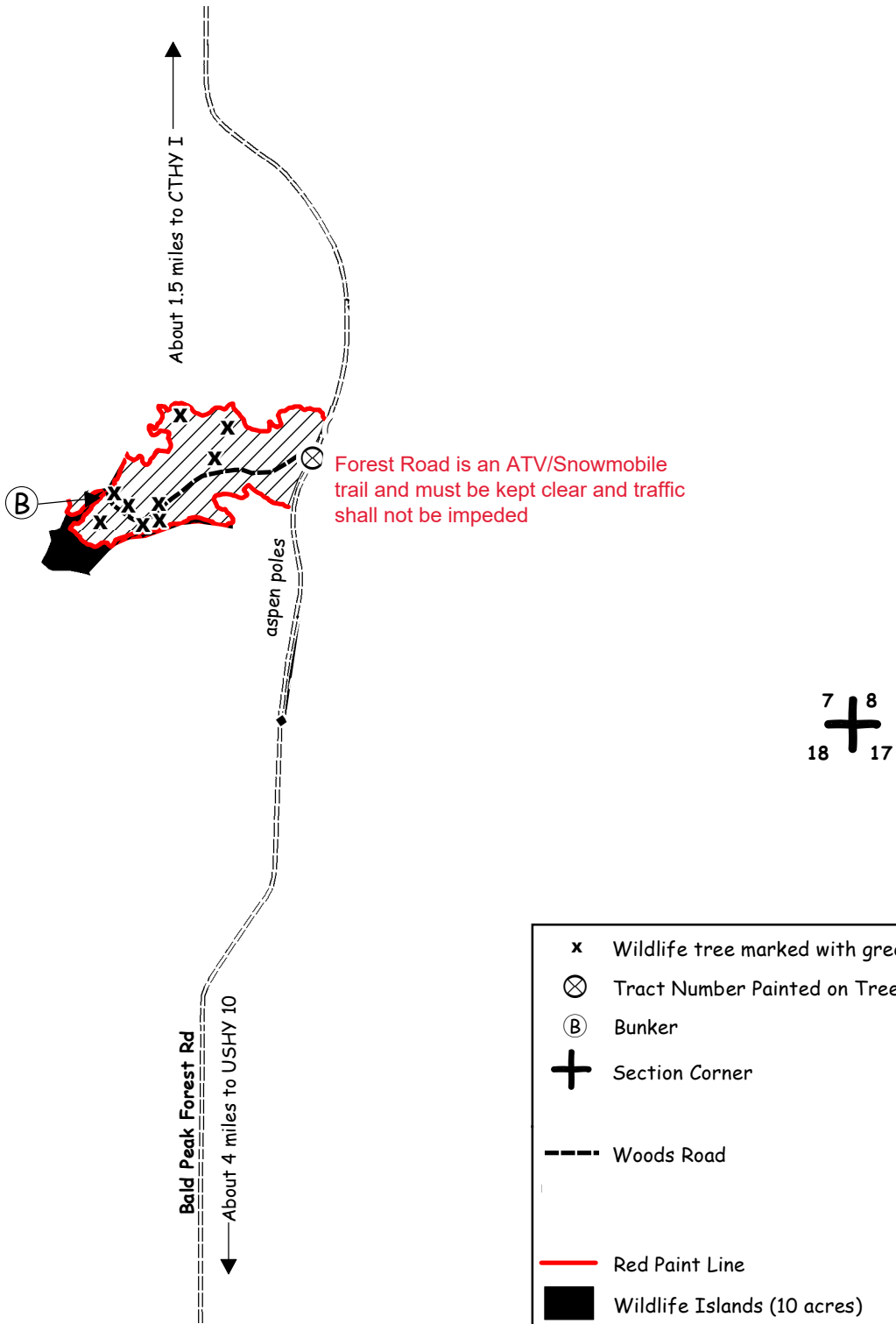

x	Wildlife tree marked with green paint. DO NOT CUT
⊗	Tract Number Painted on Tree
Ⓟ	Bunker
+	Section Corner
---	Woods Road
—	Red Paint Line
■	Wildlife Islands (10 acres)

**CLARK COUNTY FOREST**  
**Firewood Permit Area 6-22**  
**Pt. of SESE Section 23**  
**Pt of S 1/2 SW 1/4 Section 24**  
**Township 23N Range 01W (Washburn)**

 Firewood Permit Area. May harvest trim, cull pieces, and non-merchantable logging debris. Do not cut any standing trees (alive or dead), pulpwood, logs, or downed timber 8 feet or longer.

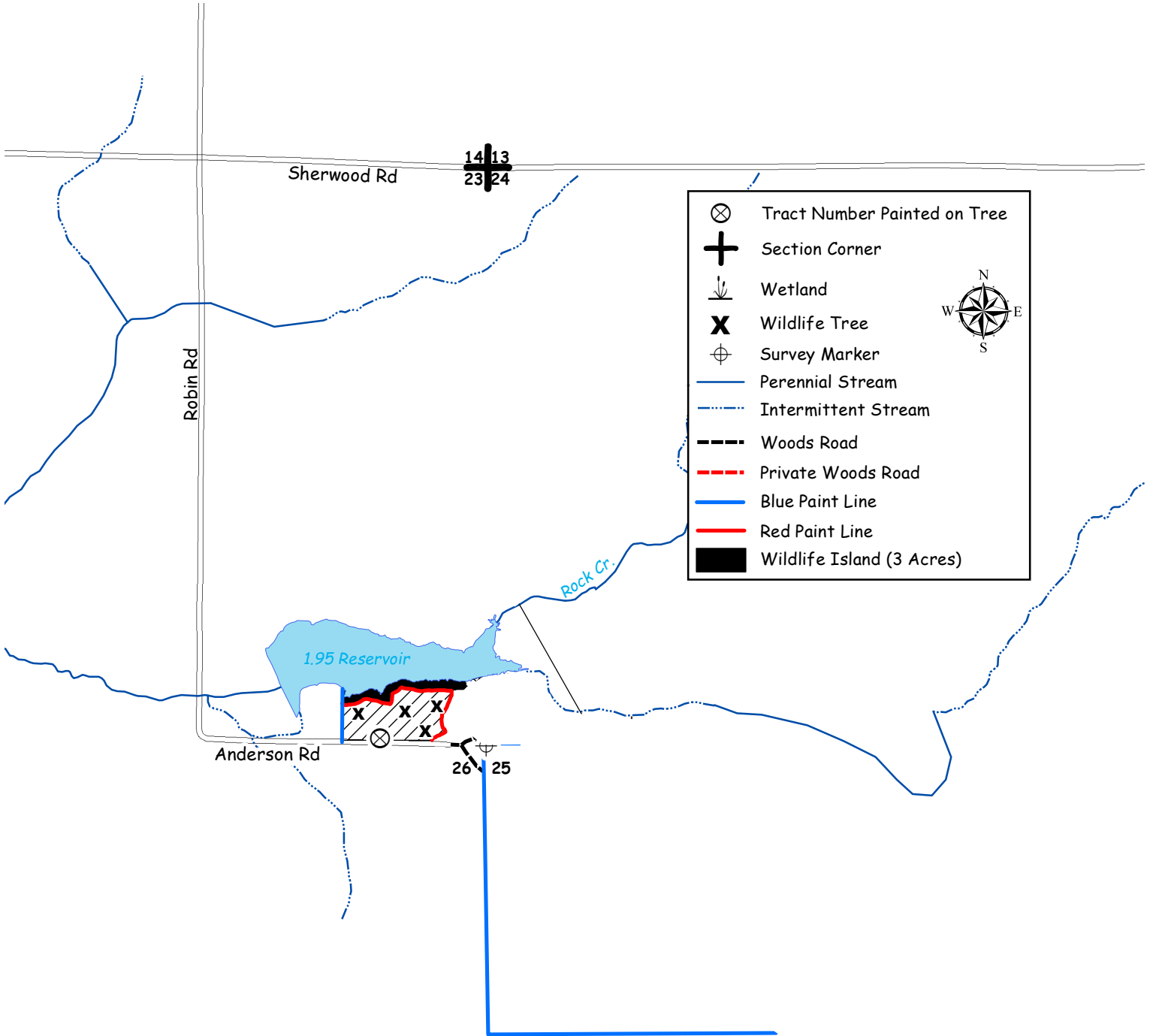

# CLARK COUNTY FOREST

Firewood Permit Area 7-22  
W1/2 SW1/4 Section 29; S1/2 Section 30;  
N1/2 NE1/4 Section 31; NWNW Section 32  
Township 25N Range 3W (Seif)



Firewood Permit Area. May harvest trim, cull pieces, and non-merchantable logging debris. Do not cut any standing trees (alive or dead), pulpwood, logs, or downed timber 8 feet or longer.

Forest Road is an ATV/  
Snowmobile trail and must  
be kept clear and traffic  
shall not be impeded

Timberlane Forest Rd

25 + 30  
36 + 31

Bald Peak Forest Rd

10

x	Wildlife tree marked with green paint. DO NOT CUT
Ⓟ	Bunker
+	Section Corner
■- - -■	Horse Trail
- - -	Woods Road
●- -●	ATV/Snowmobile Trail
—	Red Paint Line
■	Wildlife Islands (2 Acres)





**CLARK COUNTY FOREST**  
**Firewood Permit Area 9-22**  
 SESW, SWSE, SESE, NESE Sec. 10  
 SWNW, NWSW, NWSE, NESE Sec. 11  
 N1/2 SENE Sec. 15  
 Township 23N, Range 3W (Dewhurst)



Firewood Permit Area. May harvest trim, cull pieces, and non-merchantable logging debris. Do not cut any standing trees (alive or dead), pulpwood, logs, or downed timber 8 feet or longer.

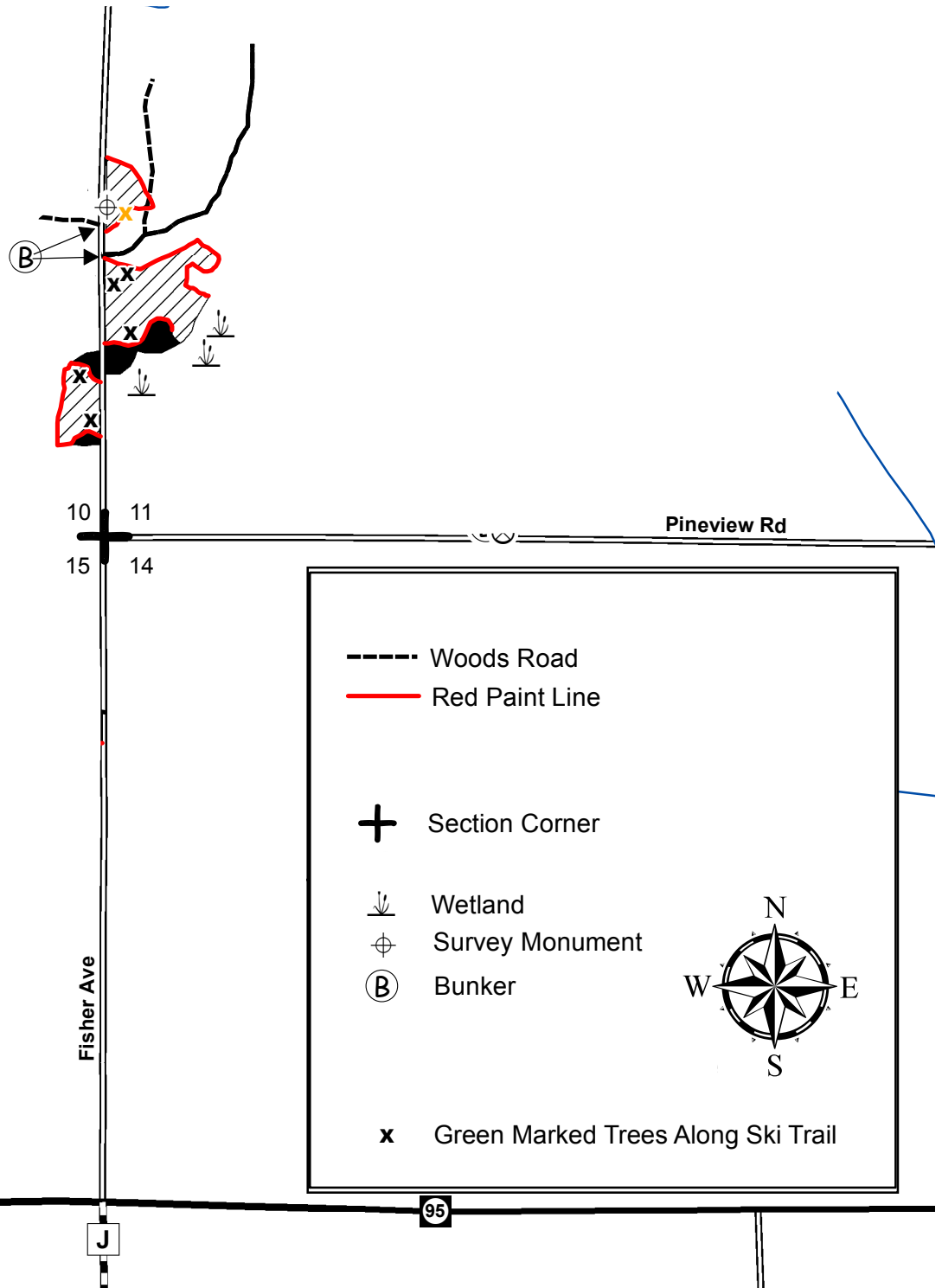

**CLARK COUNTY FOREST**  
**Firewood Permit Area 11-22**  
**Pt of SW 1/4, SWNE, NWSE Section 23**  
**Township 24N Range 3W (Hewett)**

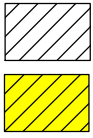

Firewood Permit Area. May harvest trim, cull pieces, and non-merchantable logging debris. Do not cut any standing trees (alive or dead), pulpwood, logs, or downed timber 8 feet or longer.

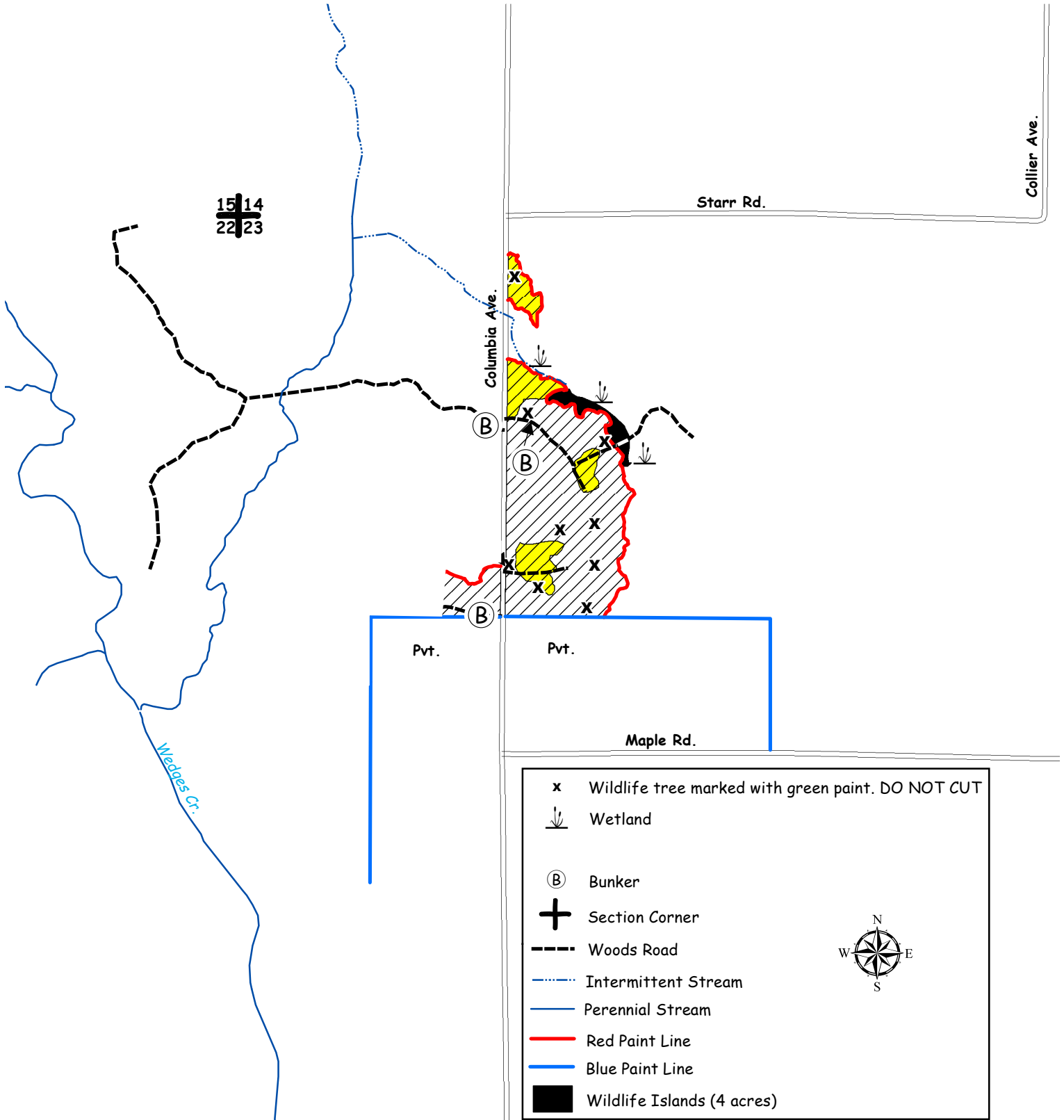

x	Wildlife tree marked with green paint. DO NOT CUT
	Wetland
(B)	Bunker
+	Section Corner
- - - -	Woods Road
⋯	Intermittent Stream
—	Perennial Stream
—	Red Paint Line
—	Blue Paint Line
■	Wildlife Islands (4 acres)



**CLARK COUNTY FOREST**  
**Firewood Permit Area 13-22**  
**NWNW, Section 17,**  
**NENE Section 18**  
**Township 27N Range 3W (Mead)**



Firewood Permit Area. May harvest trim, cull pieces, and non-merchantable logging debris. Do not cut any standing trees (alive or dead), pulpwood, logs, or downed timber 8 feet or longer.

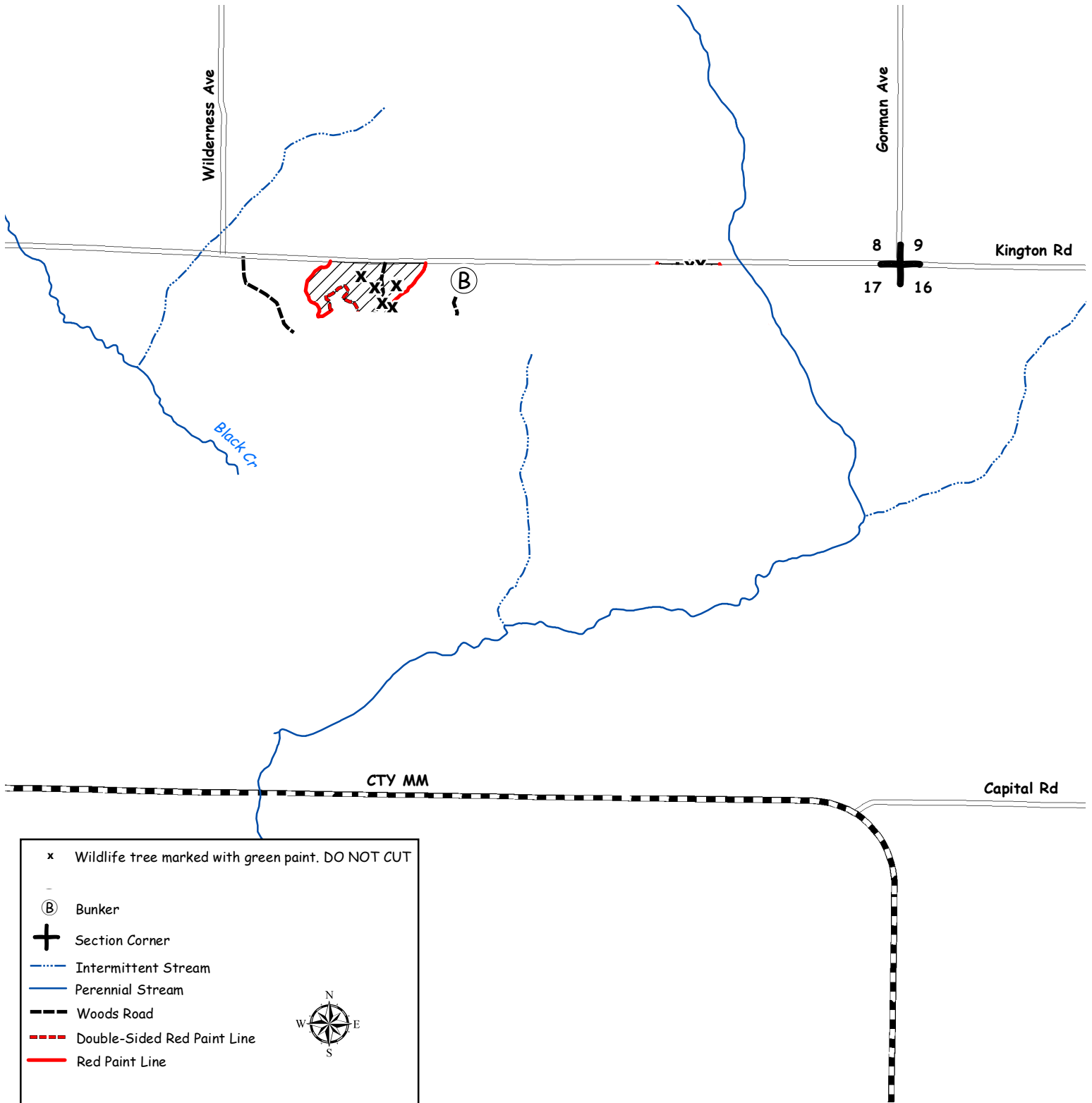

# CLARK COUNTY FOREST

## Firewood Permit Area 14-22

Pt. of NENW, NWNE, NENE Section 2  
Township 24N Range 3W (Hewett)



Firewood Permit Area. May harvest trim, cull pieces, and non-merchantable logging debris. Do not cut any standing trees (alive or dead), pulpwood, logs, or downed timber 8 feet or longer.

34 + 35  
3 | 2

ATV trail must be kept clear  
and traffic shall NOT be  
impeded.

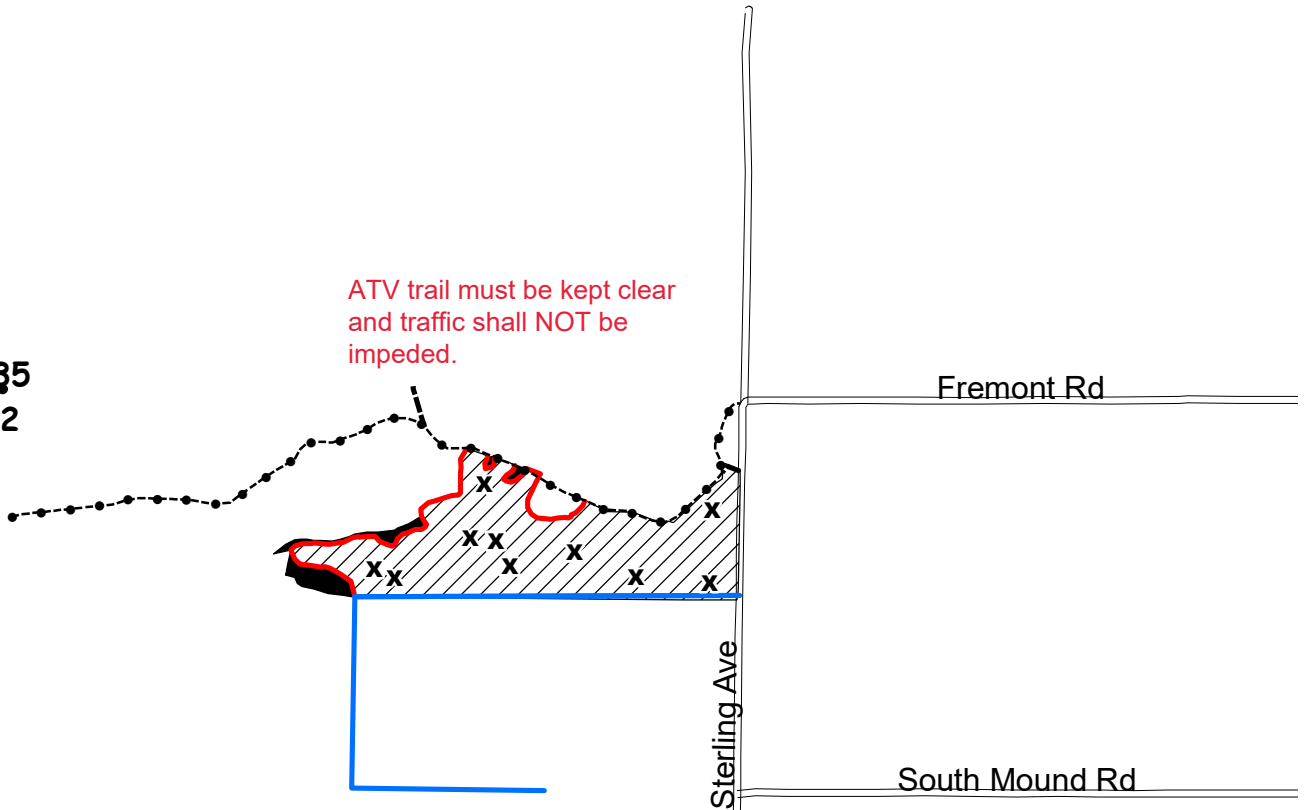

x	Wildlife Trees marked in green paint. DO NOT CUT
+	Section Corner
— (blue)	Blue Paint Line
— (red)	Red Paint Line
·-·-·-·	ATV, Trail
- - - -	Woods Road
■	Wildlife Island (3 Acres)

# CLARK COUNTY FOREST

## Firewood Permit Area 16-22

Pt. of SWSE, SESE Section 17  
Pt. of NWNE, NENE Section 20  
Township 26N Range 4W (North Foster)



Firewood Permit Area. May harvest trim, cull pieces, and non-merchantable logging debris.  
Do not cut any standing trees (alive or dead), pulpwood, logs, or downed timber 8 feet or longer.

18|17  
19|20

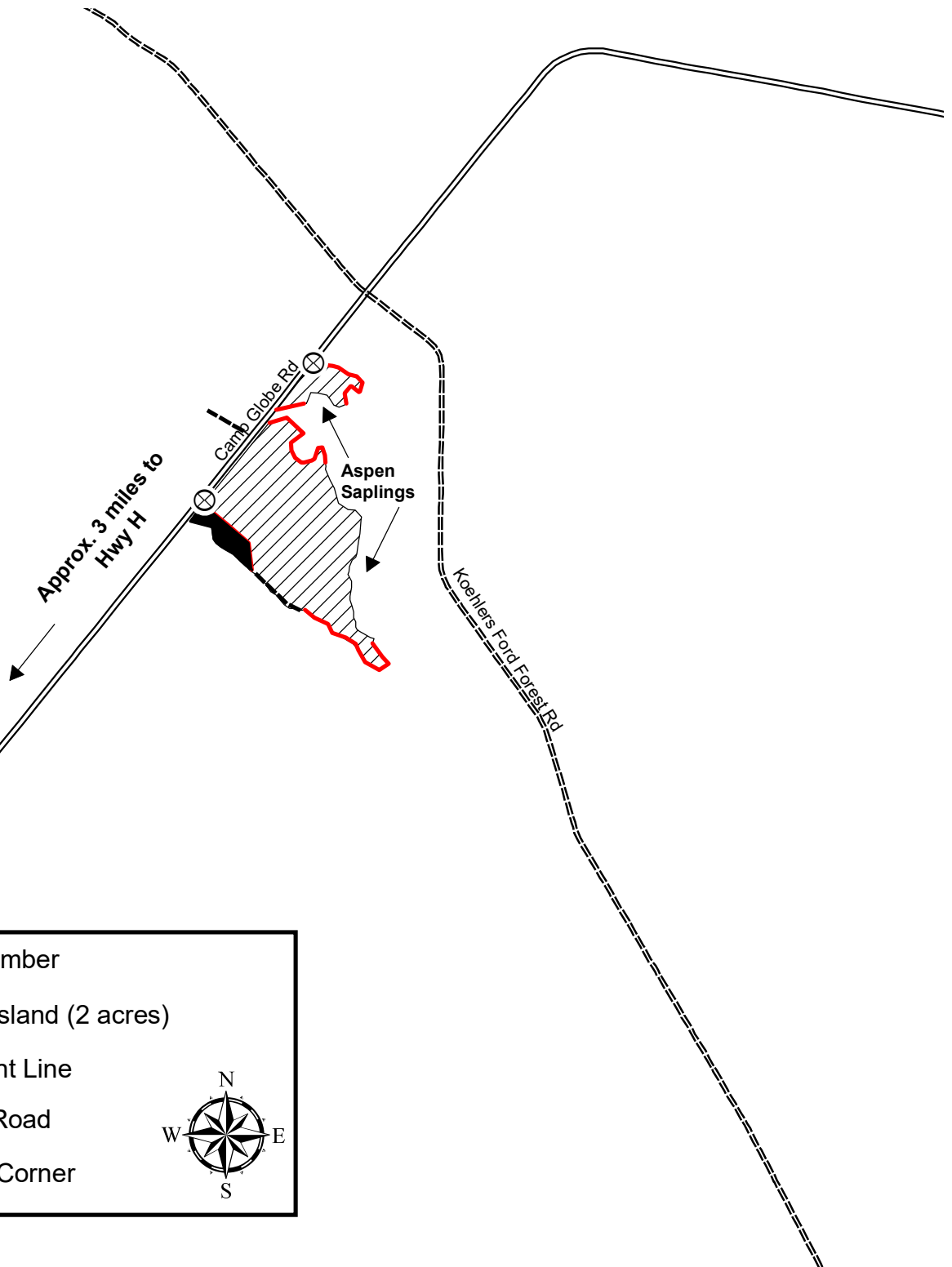

	Tract Number
	Wildlife Island (2 acres)
	Red Paint Line
	Woods Road
	Section Corner

**CLARK COUNTY FOREST**  
**Firewood Permit Area 17-22**  
**Pt. of S 1/2 N 1/2 Section 3**  
**Township 24N Range 3W (Hewett)**



Firewood Permit Area. May harvest trim, cull pieces, and non-merchantable logging debris. Do not cut any standing trees (alive or dead), pulpwood, logs, or downed timber 8 feet or longer.

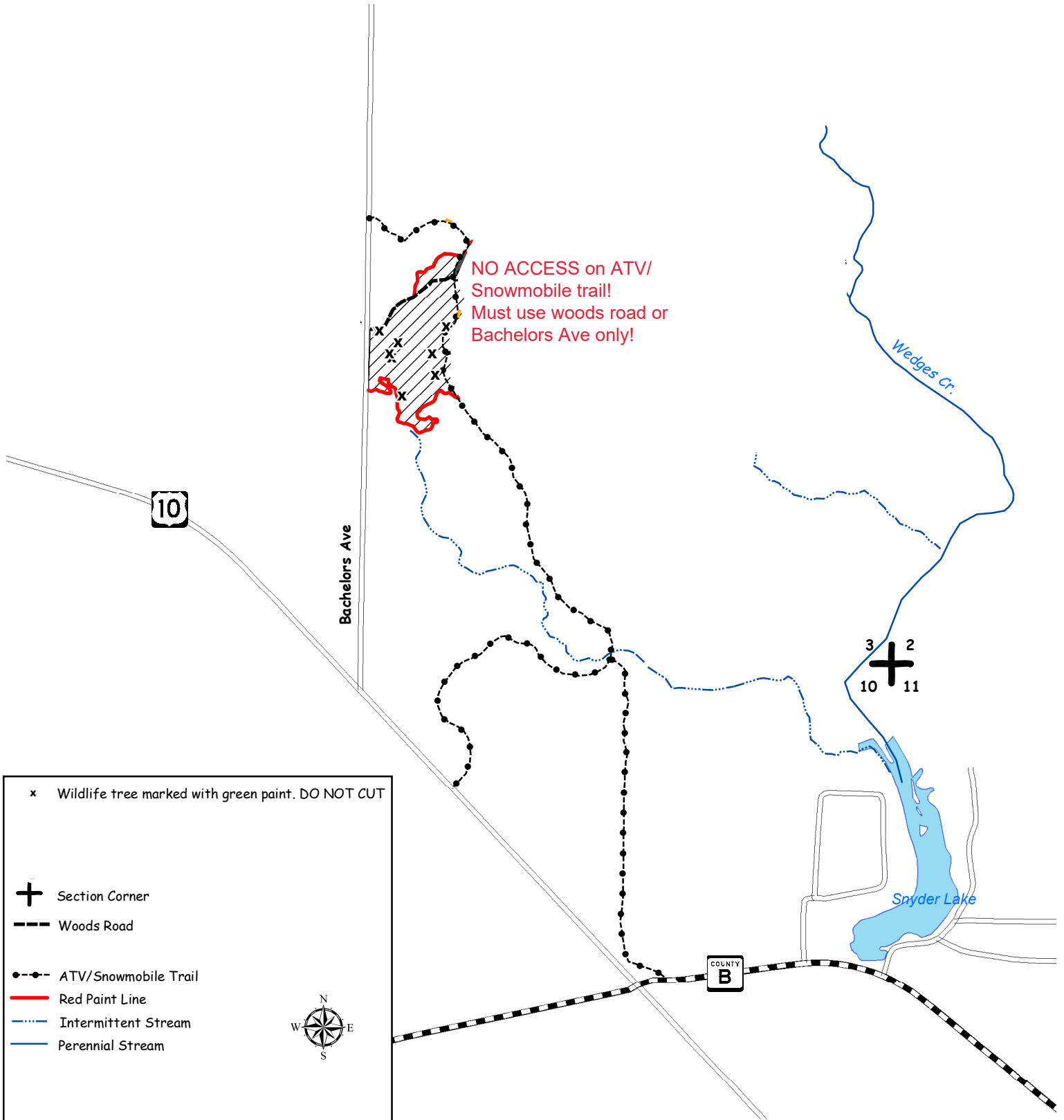

# CLARK COUNTY FOREST

## Firewood Permit Area 18-22

Pt. of SESW Section 4

Pt. of NENW Section 9

Township 23N Range 3W (Dewhurst)



Firewood Permit Area. May harvest trim, cull pieces, and non-merchantable logging debris. Do not cut any standing trees (alive or dead), pulpwood, logs, or downed timber 8 feet or longer.

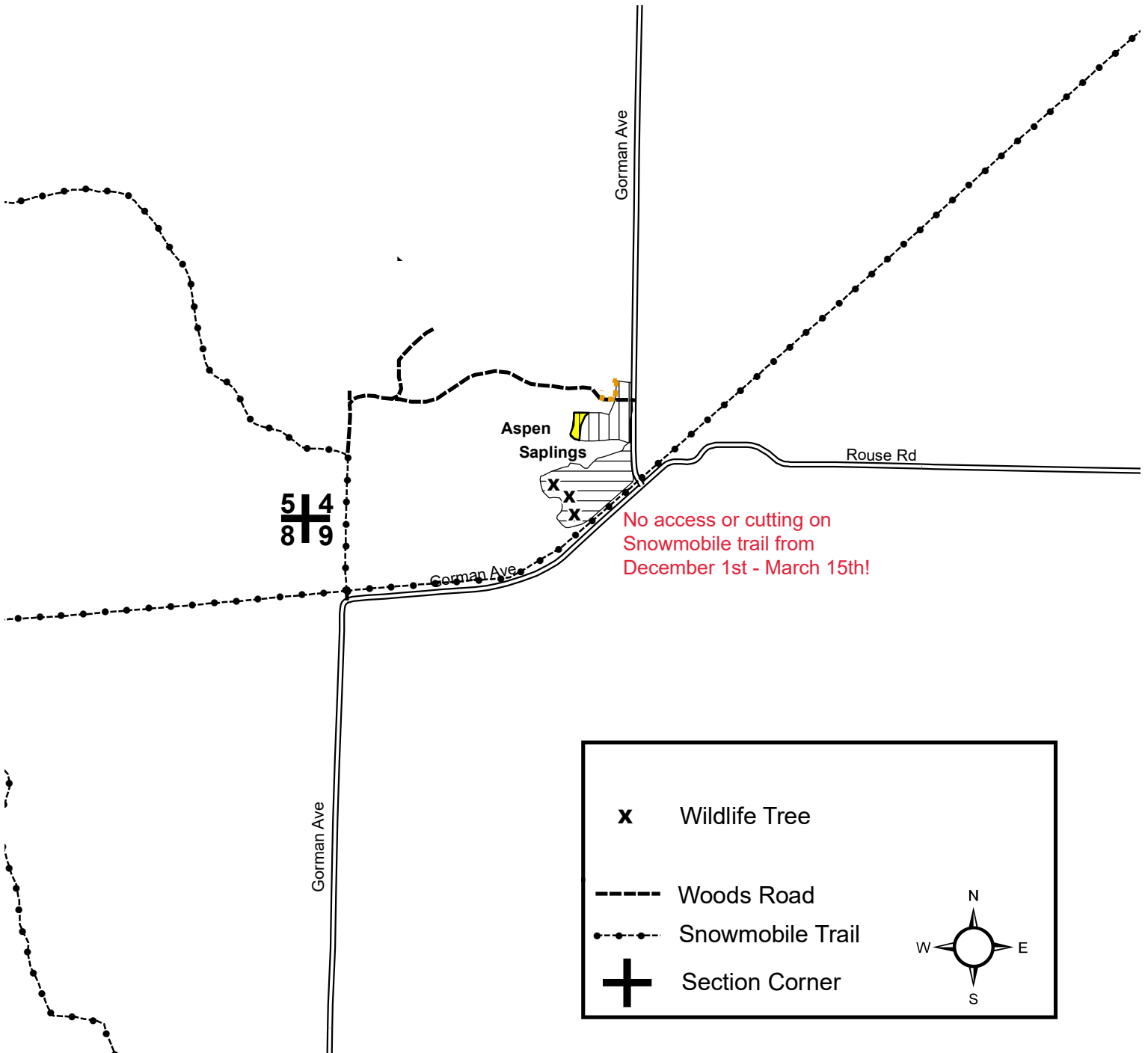

# CLARK COUNTY FOREST

## Firewood Permit Area 19-22

N1/2 SE1/4 Section 35,  
Township 25N Range 3W (Seif)



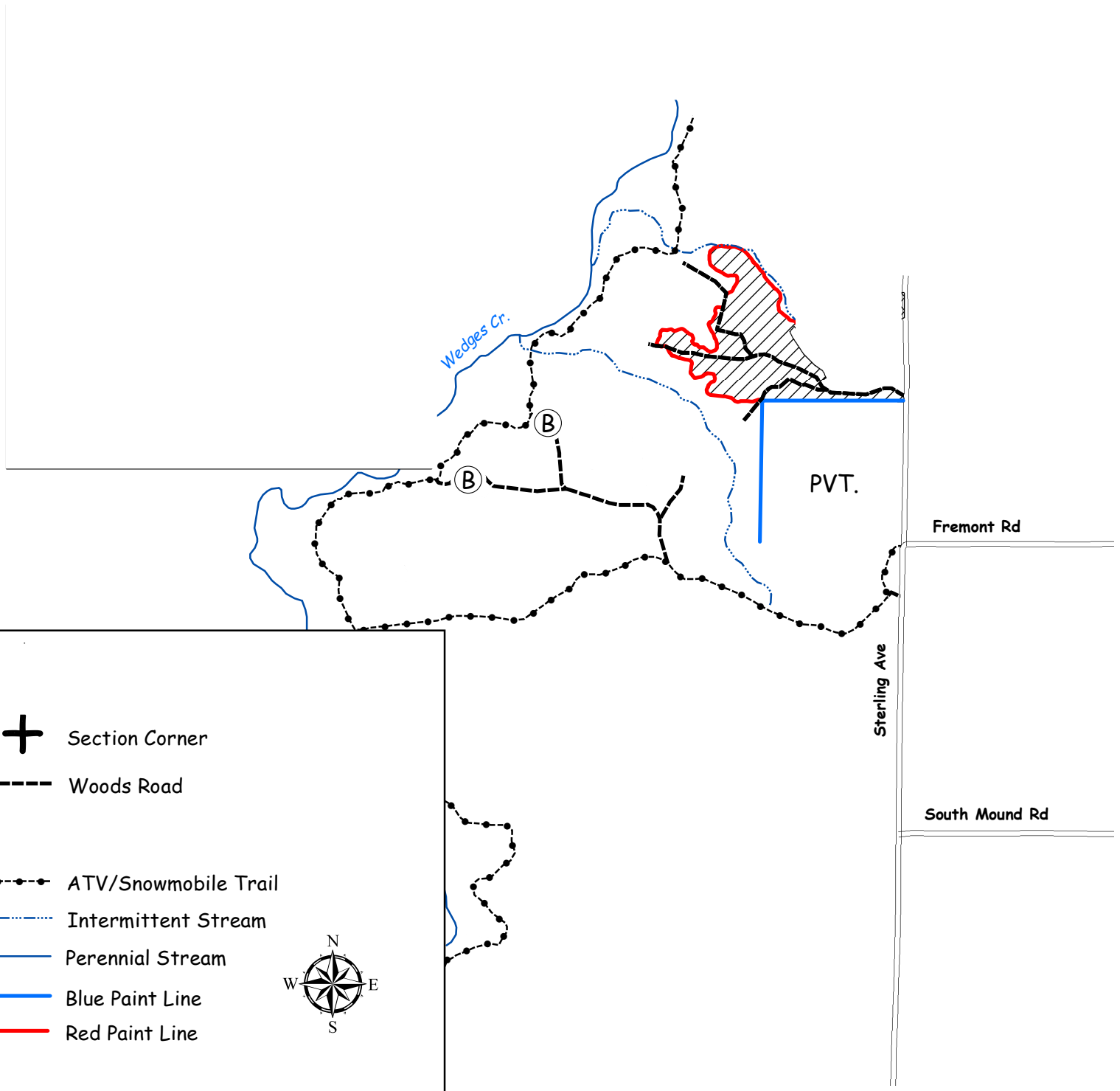

Firewood Permit Area. May harvest trim, cull pieces, and non-merchantable logging debris. Do not cut any standing trees (alive or dead), pulpwood, logs, or downed timber 8 feet or longer.





**CLARK COUNTY FOREST**  
**Firewood Permit Area 9-21**  
**Pt. of E1/2 E1/2 Section 25,**  
**NENE Section 36.**  
**Township 25N Range 4W (South Foster)**

 Firewood Permit Area. May harvest trim, cull pieces, and non-merchantable logging debris. Do not cut any standing trees (alive or dead), pulpwood, logs, or downed timber 8 feet or longer.



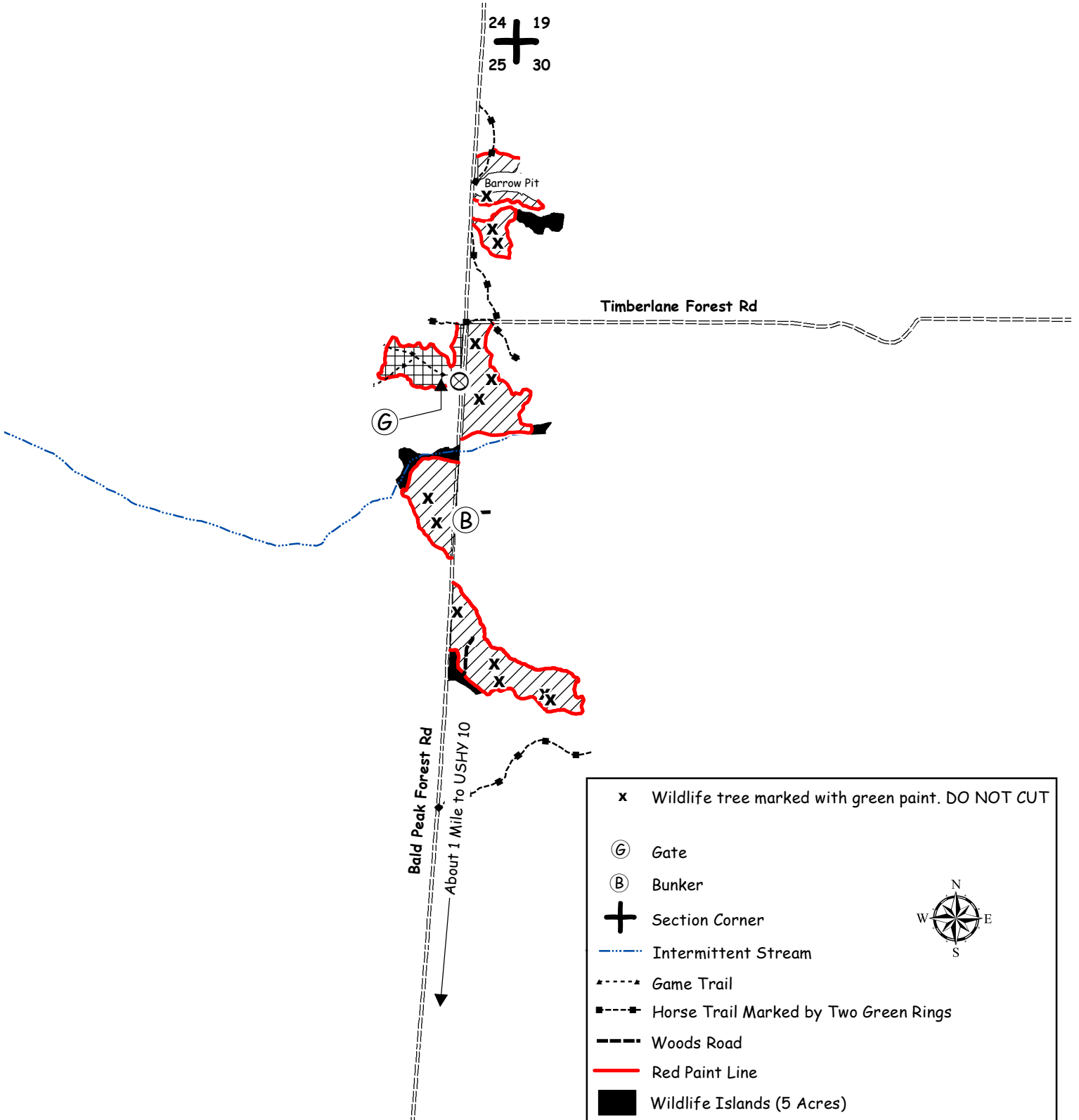

x	Wildlife tree marked with green paint. DO NOT CUT
ⓐ	Gate
ⓑ	Bunker
+	Section Corner
— · — · —	Intermittent Stream
- - - - -	Game Trail
- · - · -	Horse Trail Marked by Two Green Rings
- - - - -	Woods Road
— — — — —	Red Paint Line
■	Wildlife Islands (5 Acres)



**CLARK COUNTY FOREST**  
**Firewood Permit Area 11-21**  
**NWSW, SWSW, SESW Section 26**  
**SESE Section 27**  
**NWNW, NENW Section 35**  
**Township 23N Range 3W (Dewhurst)**



Firewood Permit Area. May harvest trim, cull pieces, and non-merchantable logging debris. Do not cut any standing trees (alive or dead), pulpwood, logs, or downed timber 8 feet or longer.

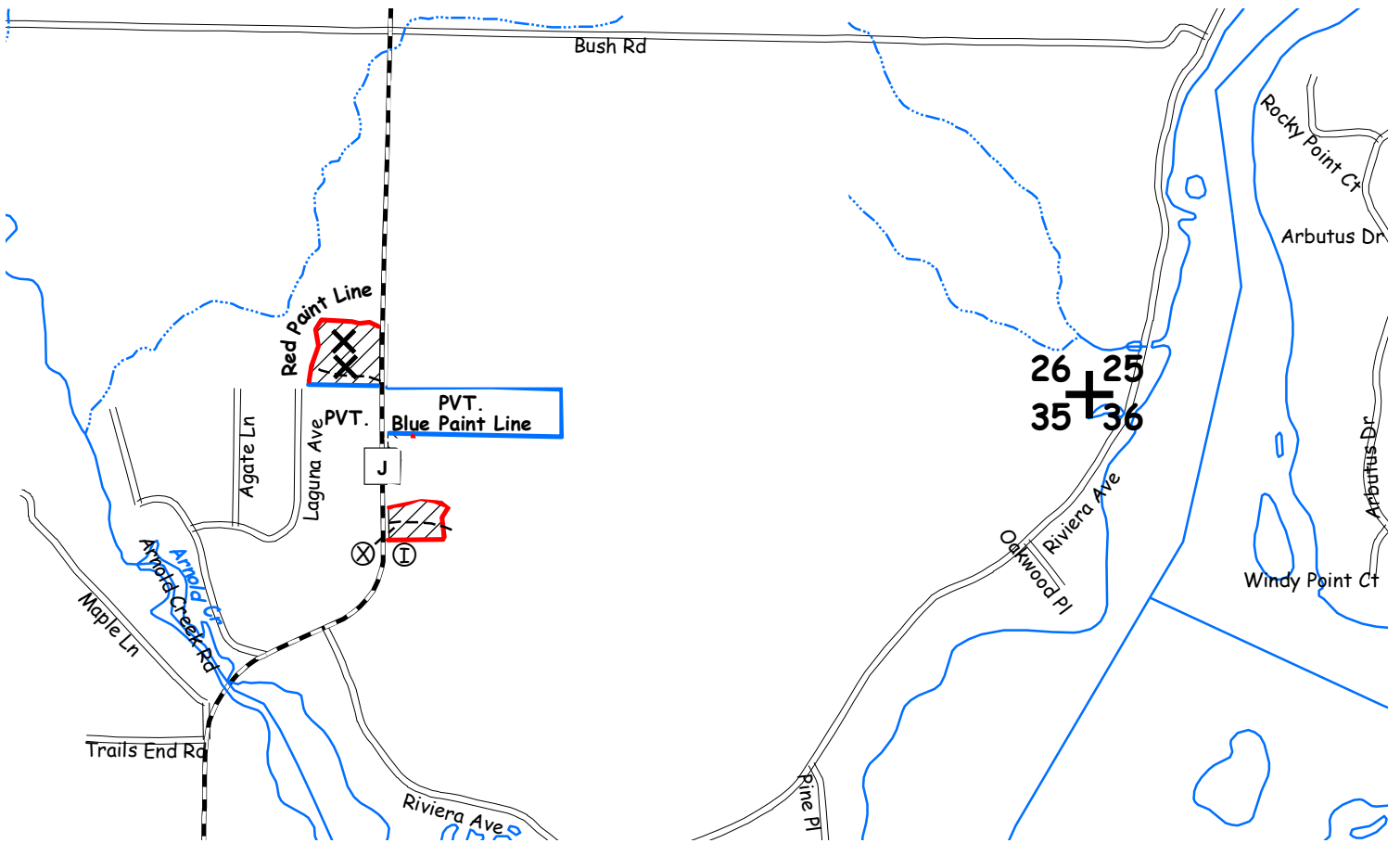

- Blue Paint Line (Property Boundary)
- Red Paint Line
- X** Wildlife tree marked with green paint. DO NOT CUT.
- I** Wildlife island behind RED or GREEN paint lines. DO NOT CUT.
- - - -** Woods Road
- Perennial Stream
- - - - Intermittent Stream

