



## Courthouse Map

6th Street

Clark County Jail Entrance

Courthouse Entrance

Court Street

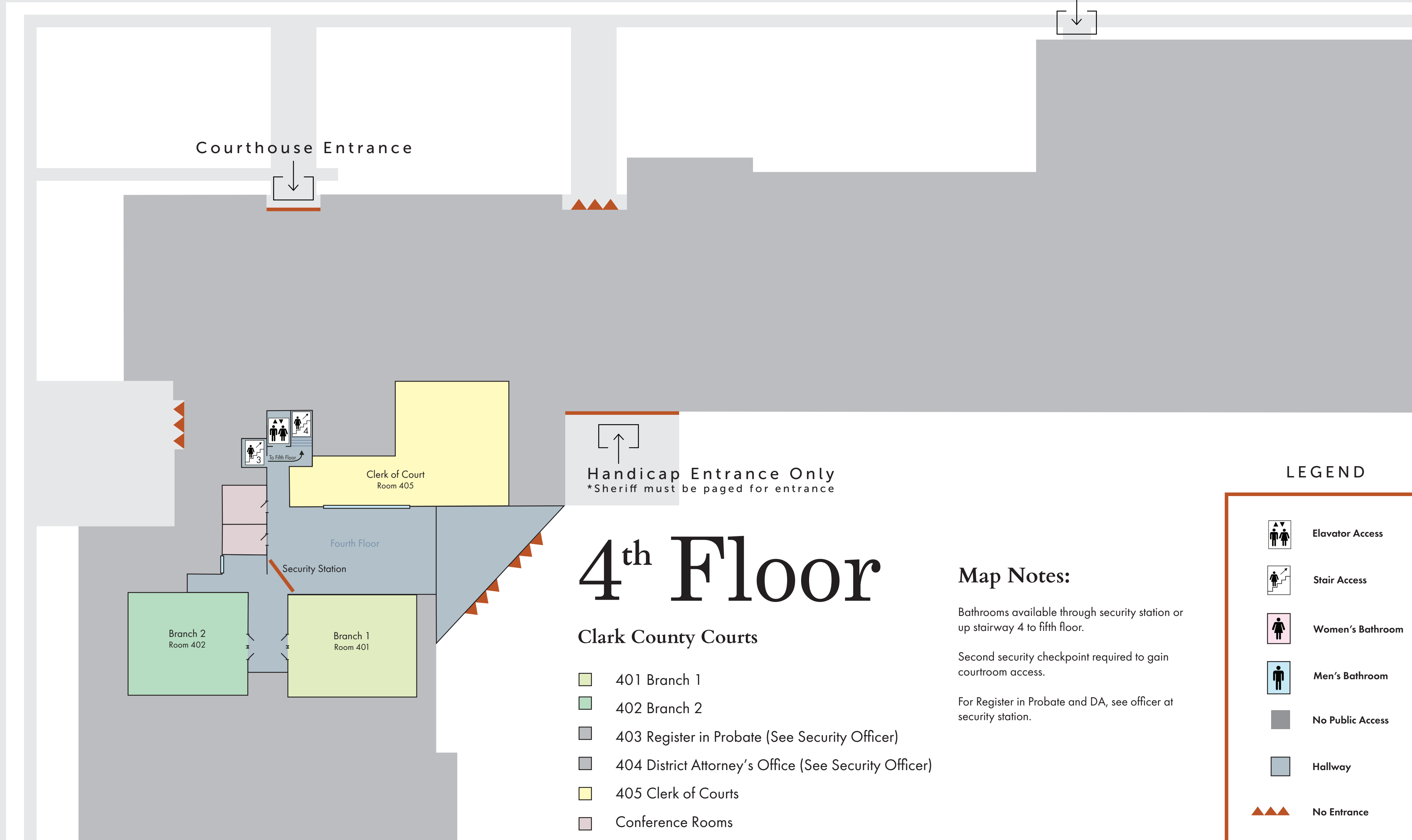

Handicap Entrance Only  
\*Sheriff must be paged for entrance

# 4<sup>th</sup> Floor

## Clark County Courts

- 401 Branch 1
- 402 Branch 2
- 403 Register in Probate (See Security Officer)
- 404 District Attorney's Office (See Security Officer)
- 405 Clerk of Courts
- Conference Rooms

## Map Notes:

Bathrooms available through security station or up stairway 4 to fifth floor.

Second security checkpoint required to gain courtroom access.

For Register in Probate and DA, see officer at security station.

## LEGEND

-  Elevator Access
-  Stair Access
-  Women's Bathroom
-  Men's Bathroom
-  No Public Access
-  Hallway
-  No Entrance
-  Window
-  Security Station