



CLARK COUNTY, WISCONSIN

Courthouse Map

6th Street

Clark County Jail Entrance

Courthouse Entrance

Court Street

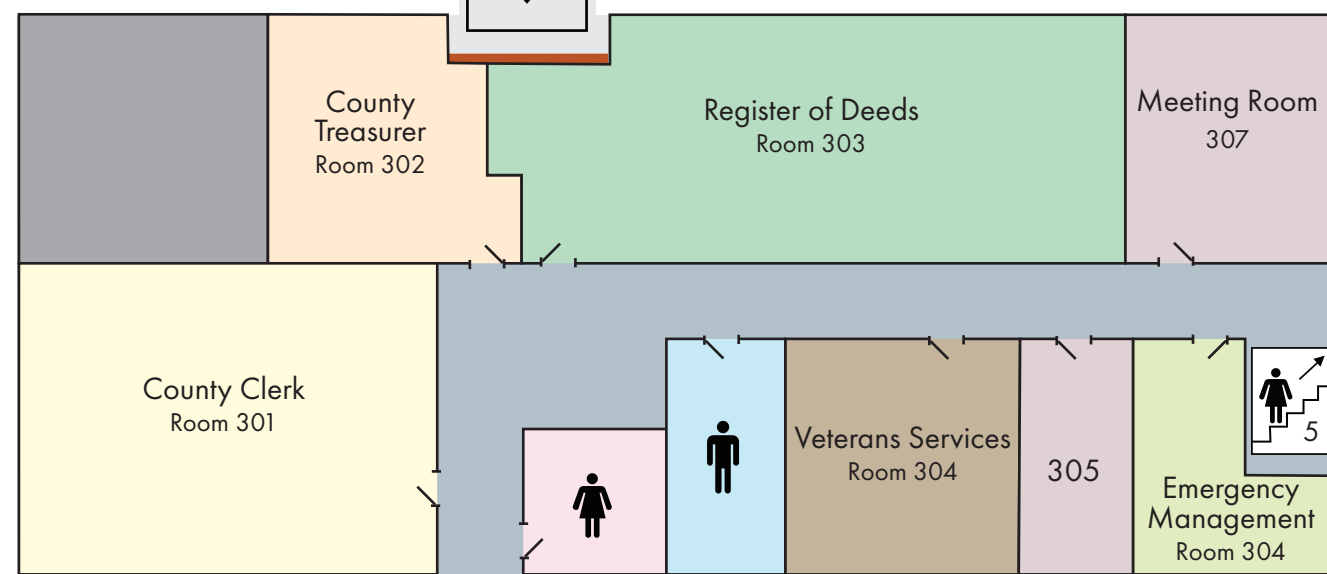

Handicap Entrance Only
*Sheriff must be paged for entrance

3rd & 2nd Floor

Departments

Second Floor

- 201 ADRC/Aging
- 204 Planning & Zoning
- 205 Personnel

Third Floor

- 301 County Clerk
- 302 County Treasurer
- 303 Register of Deeds
- 304 Veterans Services
- 305 Meeting Space
- 306 Emergency Management
- 307 Meeting Space
- 308 Sheriff's Office

Map Notes:

3rd floor is accessible via second floor by Stairway 2 (Small stairway by elevator)

You can return to first floor utilizing the elevator, Stairway 1, or Stairway 5.

LEGEND

- Elevator Access
- Stair Access
- Women's Bathroom
- Men's Bathroom
- No Public Access
- Hallway
- No Entrance
- Window
- Security Station